

# How to add or delete a Wifi network on Mac OS X

If you want to add or delete a Wifi network for any reason. For other operating systems, adding or deleting a Wifi network is too simple. What about Mac OS X? Together refer to the article below.

Your computer is running Mac OS X and you want to add or delete a Wifi network for some reason but you don't know how to do it yet. In the article below, Network Administrator will show you how to add or delete a Wifi network on Mac OS X. The steps are not as difficult as you think.

## 1. Delete a Wifi network

First open **Network Preferences** , then click "**Advanced**".

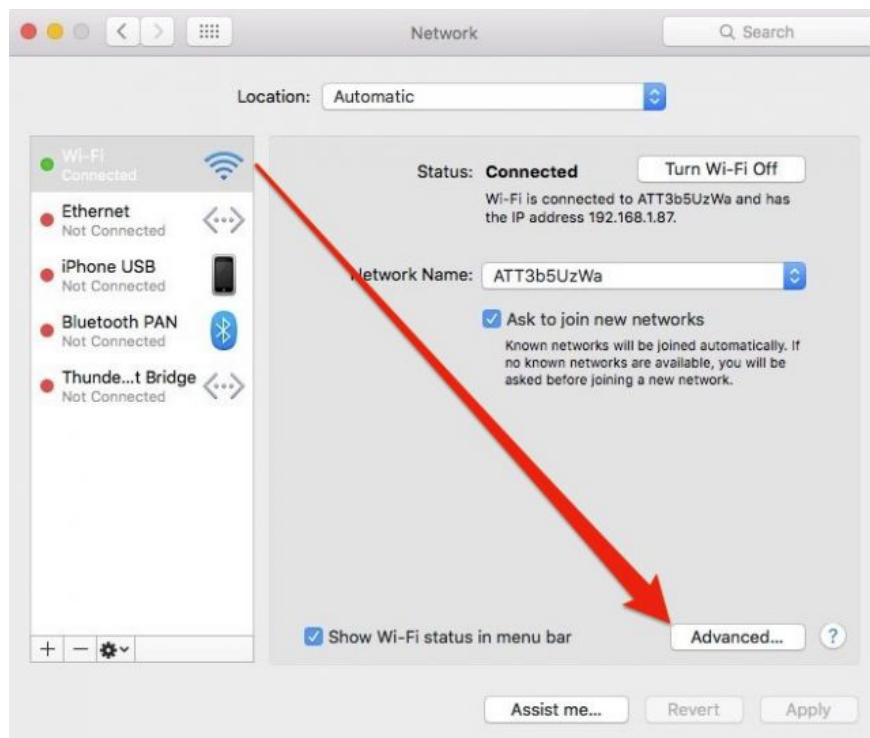

After opening the **Advanced Panel** , select the name of the Wifi network you want to delete and click on the "-" button .

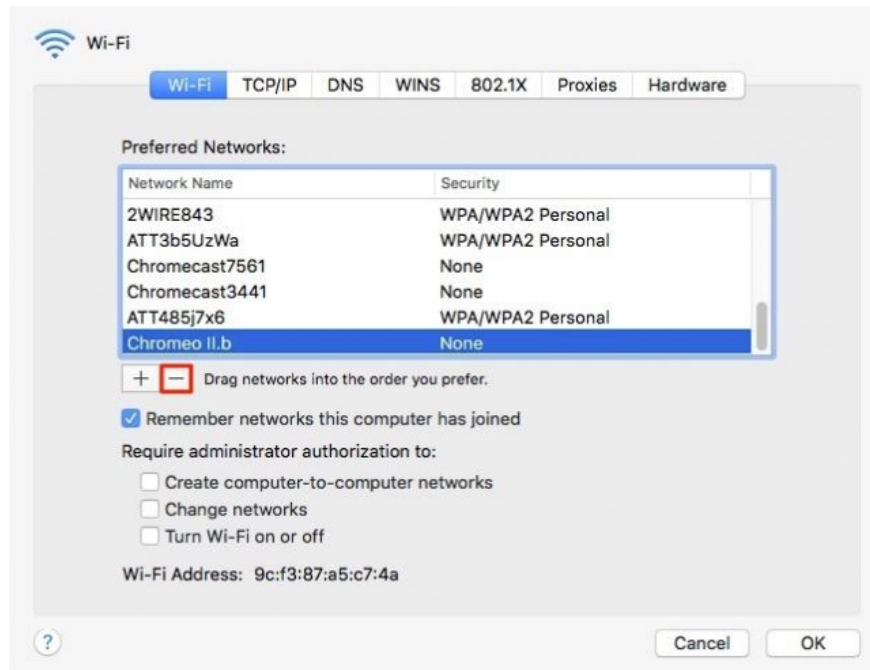

Next a warning dialog appears asking you to confirm whether you want to delete that Wifi network. Click on **"Remove"** to delete that Wifi network from the list of saved Wi-Fi networks.

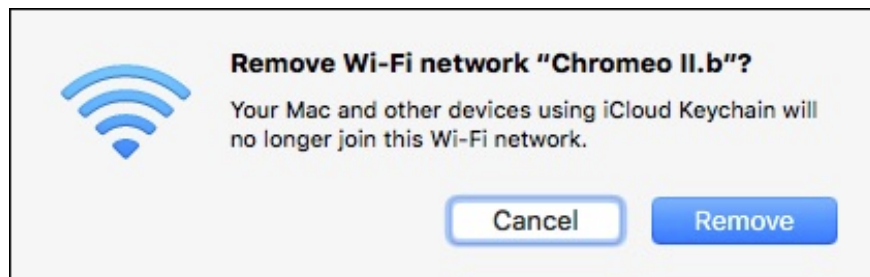

**See also: Create ZIP file in just two steps in Mac OS X**

## **2. Add a Wifi network**

Similar to how you delete a Wifi network, first open **Network Preferences** , then click on '**Advanced**'.

However, after the **Panel Advanced** appears, click on the '+' button.

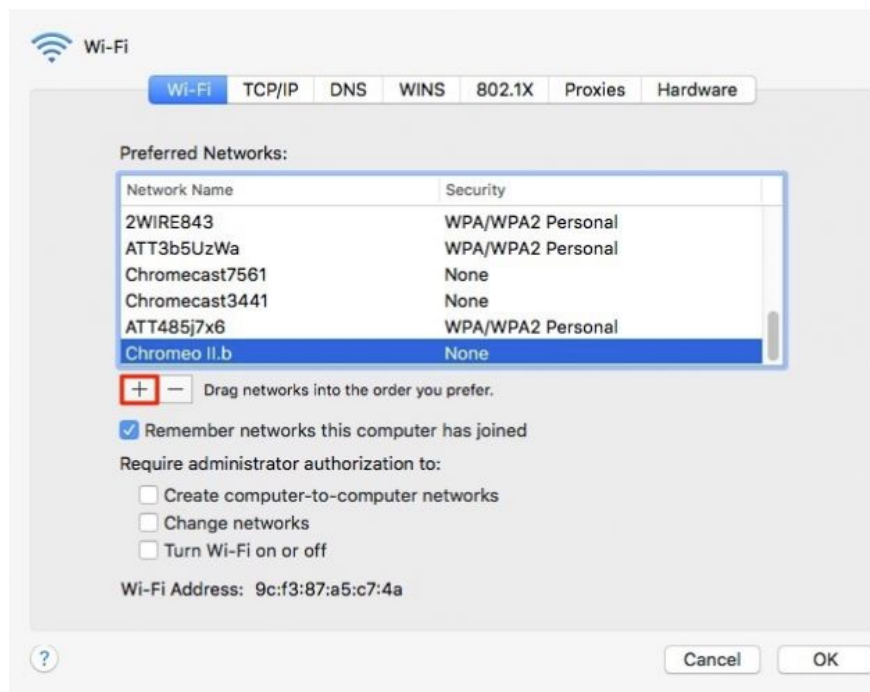

Then enter the full information of the new Wifi network name you created, the password and choose the Wifi security standard (WEP, WPA / WPA2, .).



**Good luck!**

You finished reading the article "**How to add or delete a Wifi network on Mac OS X**" edited by the [TipsMake](#) team. We hope this article has provided you with many useful tech tips and tricks. You can search for similar articles on tips and guides. Thank you for reading and for following us regularly.