

How to add multiple clocks for different time zones in Windows

If you have relatives or clients in different time zones, updating their local time is essential. To make this easier, you can add a secondary clock in Windows for different time zones.

If you have relatives or clients in different time zones, keeping their local time updated is essential. To make this easier, you can add secondary clocks in Windows for different time zones. This guide will show you several ways to set up secondary clocks in Windows to track multiple time zones simultaneously.

Add up to two additional clocks via Windows Settings.

In addition to your local clock, you can add up to two secondary clocks to track different time zones. Open Windows Settings and go to **Time & language > Date & time**. You can also right-click on the date and time in the taskbar and select **Adjust date and time**. Here, open the **Show time and date in the System tray** option.

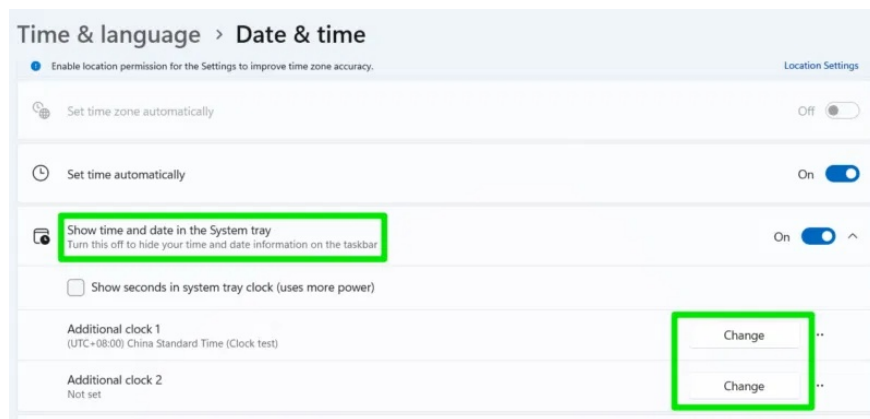

You'll find two clocks here: **Additional clock 1** and **Additional clock 2**. Click the **Change** button next to either of them, and you can choose a time zone and a display name for it.

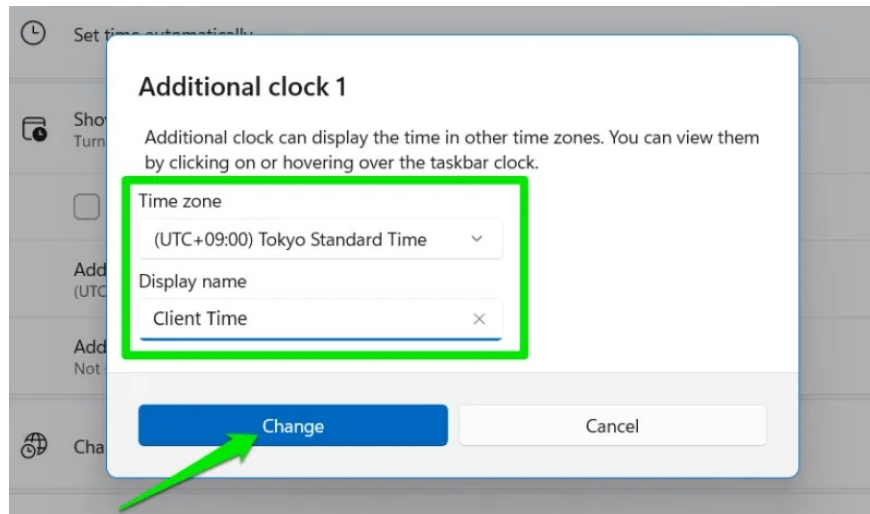

Once configured, you can view the time on these additional clocks by hovering over the date and time in the system tray. You can also simply click on the date and time to view them in the Notification Center.

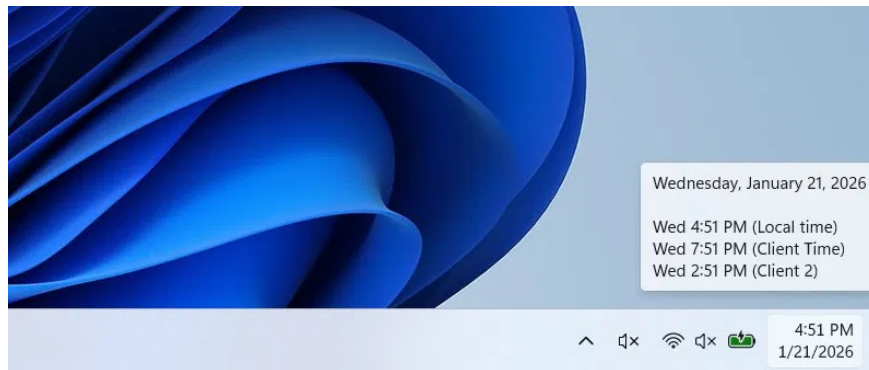

Pin multiple time zones to the Start menu.

If you want to view more than two time zones in Windows, the Clock app is the best option. You can add and view different time zones in it, and even pin them to the Start menu for quick access. Here's how:

Search for 'clock' in Windows Search and open the Clock app. Select **World Clock** in the left-hand panel and then click **Add a new city** (the + icon) in the bottom-right corner.



You can select time zones by city name here. Simply select your city and click **Add** to display it in the main World clock. Repeat the process to add as many time zones as you like.

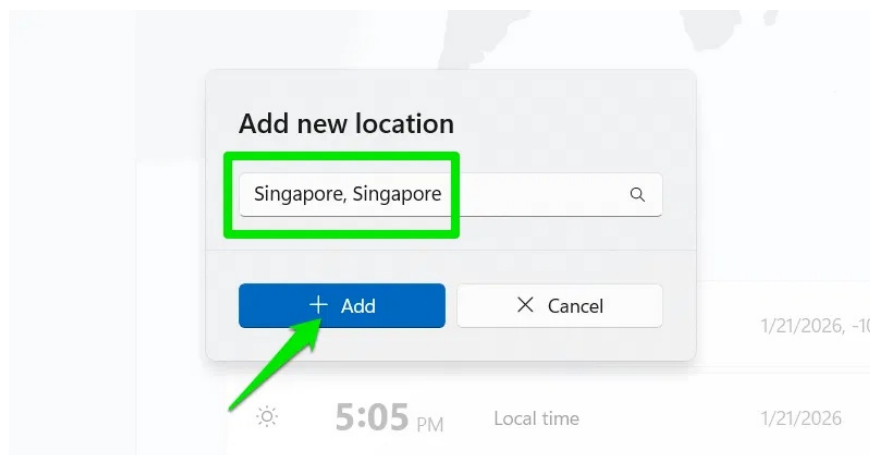

For quicker access, right-click on the time zone and select **Pin to Start**.

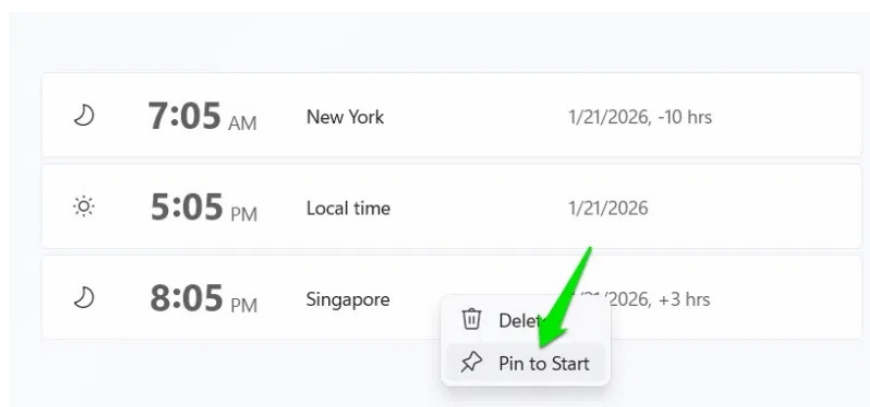

This will add a Clock app shortcut to the Start menu. Click on it to directly open the World Clock section with all your selected time zones. Since it displays all selected time zones, you only need to pin one time zone for quick access to all of them.

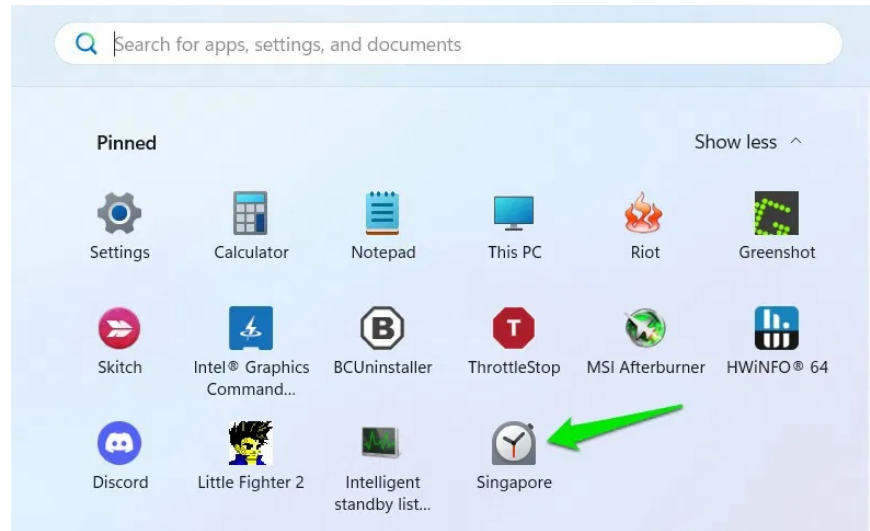

Add multiple time zone clocks to the Windows Widgets panel.

For quicker access, you can also add the World Clock widget to the Windows Widgets panel. Simply hover over the Widgets item on the taskbar, and it will display the clock along with other widgets. Even if you've customized the taskbar to hide widgets, you can still press **Win + W** to quickly open and view the clock.

For this purpose, the article recommends using the Globe Time Widget, which allows you to add an unlimited number of time zones for free to display in the Widgets panel. After installation, click the + icon in the Widgets panel, select **Globe Time** from the list, and click **Pin**.

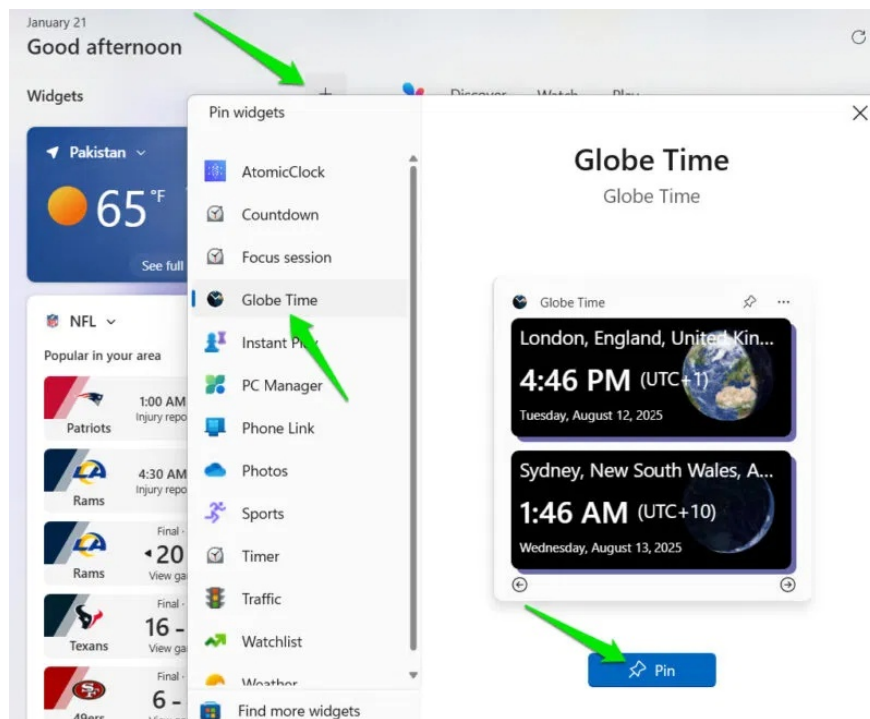

After adding it, you can click on the dot menu on it and select **Customize widget** to add/remove time zones.

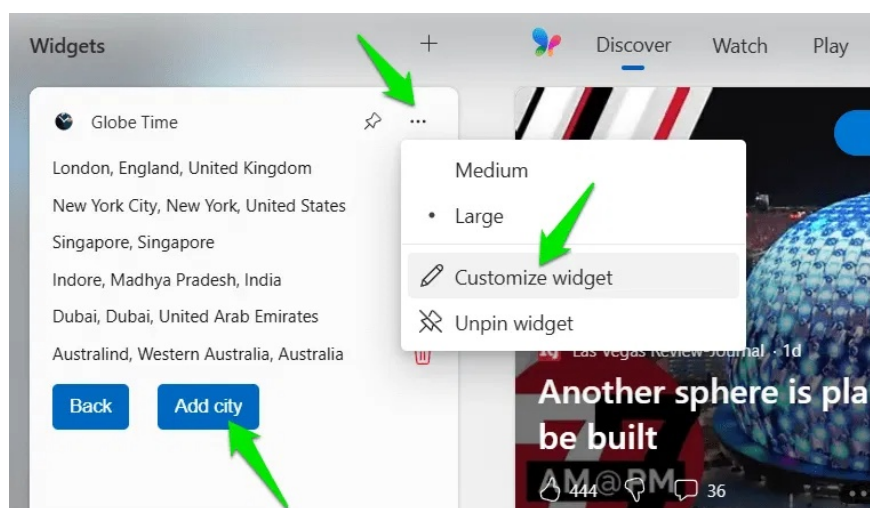

The widget will display three time zones simultaneously. If there are more than three clocks, you can click the arrow at the bottom to view the next three. The three clocks you switch to using the arrow will become the default clocks displayed when the Widgets panel is opened.

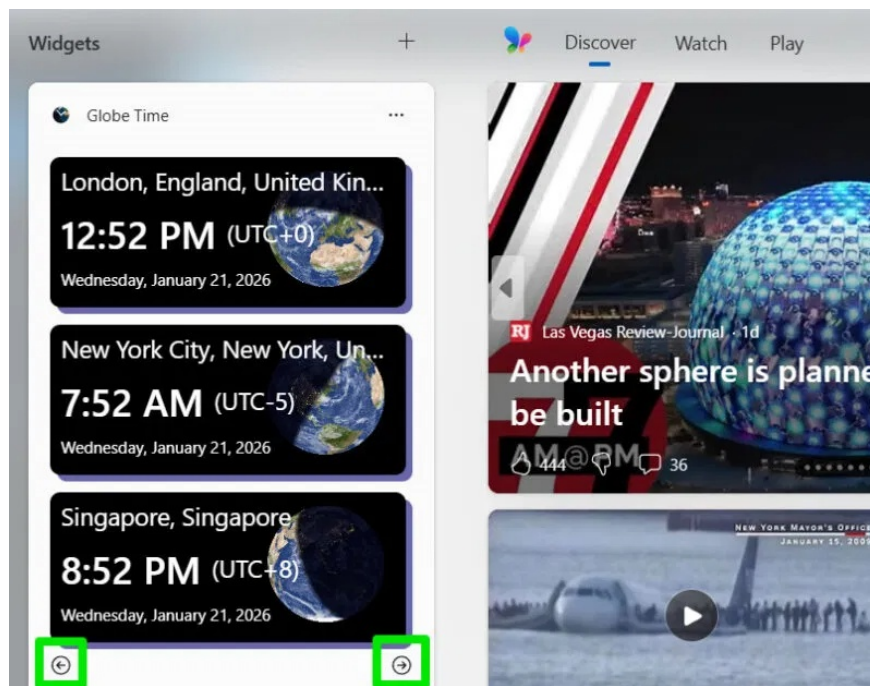

Add more clocks to your Windows desktop.

If you want to quickly check the time in different time zones, you should add a clock to your desktop. This article recommends using the Widget Launcher application for this purpose. It allows you to add Windows 7-style desktop widgets to your Windows computer. Although there are many widgets, use the World Clock widget, which allows you to add up to 5 clocks to your desktop.

After installation, select the **World Clock** widget and you'll see options to customize it. You can fully customize the clock's colors and opacity here, including the background, border, font, and accent color. After customizing, click **Launch Widget** to place it on your desktop.

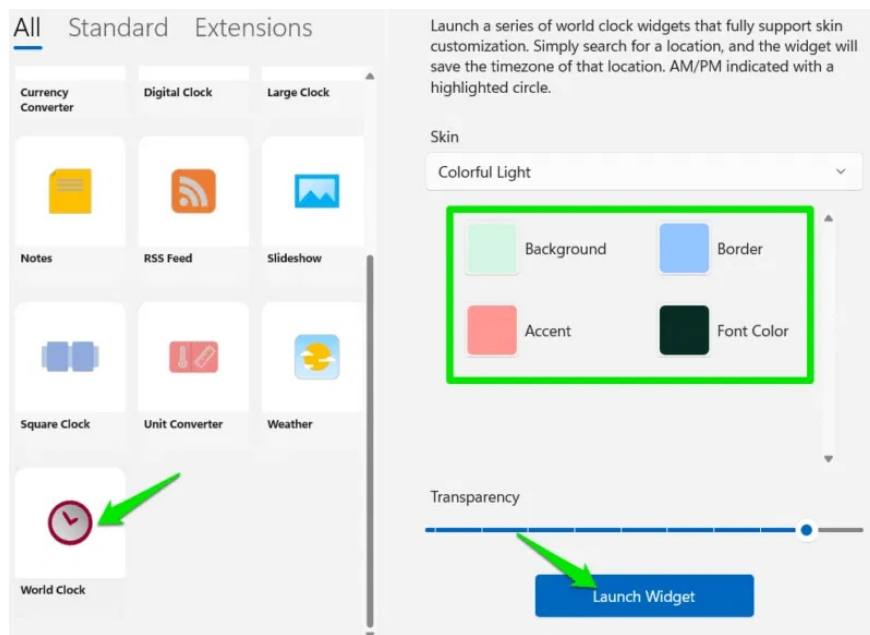

You can move and resize the desktop clock as you wish. By default, it will display the local time. Click on **Settings** (gear icon) on the clock to search for and select a time zone. You can repeat the process to add up to 5 desktop clocks displaying the time from different time zones.

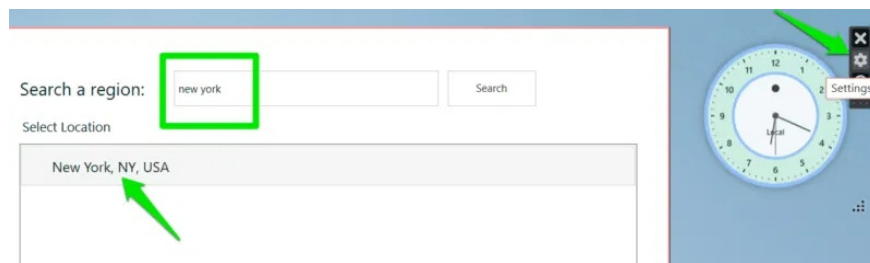

With these methods, you can always stay perfectly synchronized with colleagues and family no matter where they are in the world. If you want even more customization, you can consider using Rainmeter to add highly customizable clock widgets.

Good luck with your project!

See more:

1. Causes of incorrect time on Windows 10 and how to fix it.
2. How to change the time, date, and month in Windows 10?
3. How to make Windows tell you the time every hour.
4. How do I change the date and time format on Windows?

You finished reading the article "**How to add multiple clocks for different time zones in Windows**" edited by the [TipsMake](#) team. We hope this article has provided you with many useful tech tips and tricks. You can search for similar articles on tips and guides. Thank you for reading and for following us regularly.