

How to add fonts to Microsoft Paint

Microsoft Paint doesn't allow you to add fonts directly. Instead, you need to install the fonts you want to use into Windows, and Paint will automatically recognize those new fonts.

Microsoft Paint doesn't allow you to add fonts directly to the application. Instead, you need to install the fonts you want to use into Windows, and Paint will automatically detect those new fonts for you to use. Below are instructions on how to add fonts to Microsoft Paint.

Instructions on how to install fonts in Microsoft Paint

Step 1:

First, you need to download the fonts to your computer as usual.

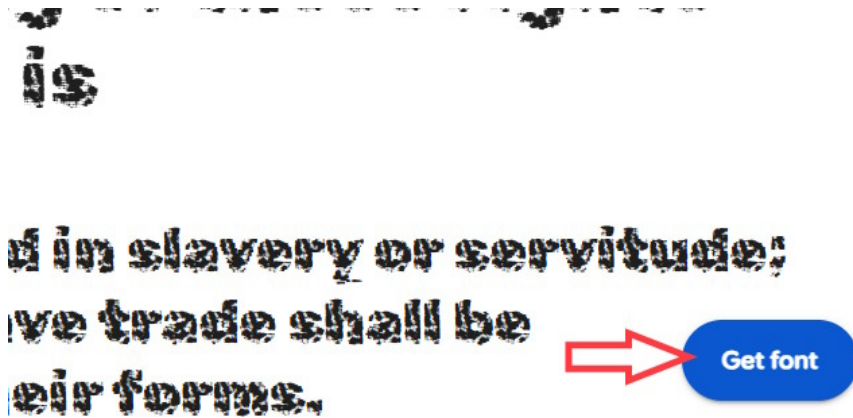

Next, we extract the folder and install the newly downloaded font on our computer.

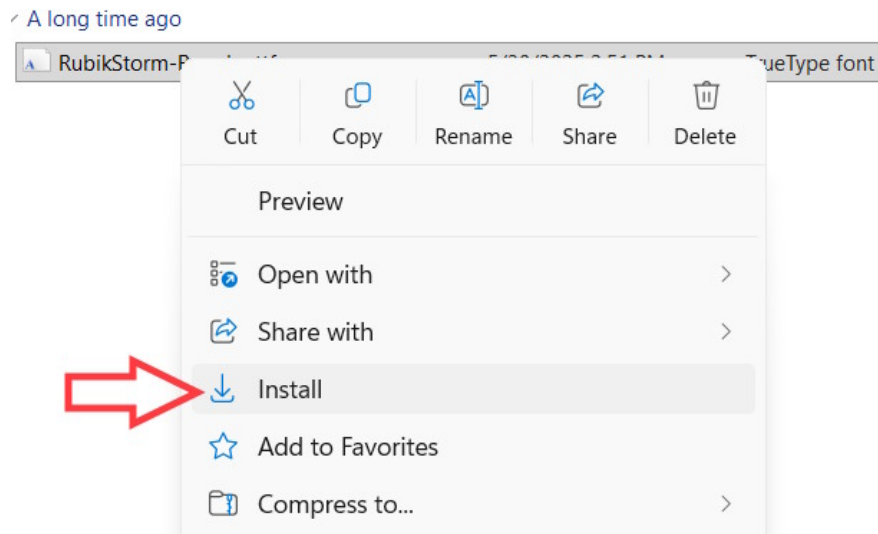

Step 2:

Open the Paint application on your computer, then click **the A icon** to search for fonts available on Windows and within the application.

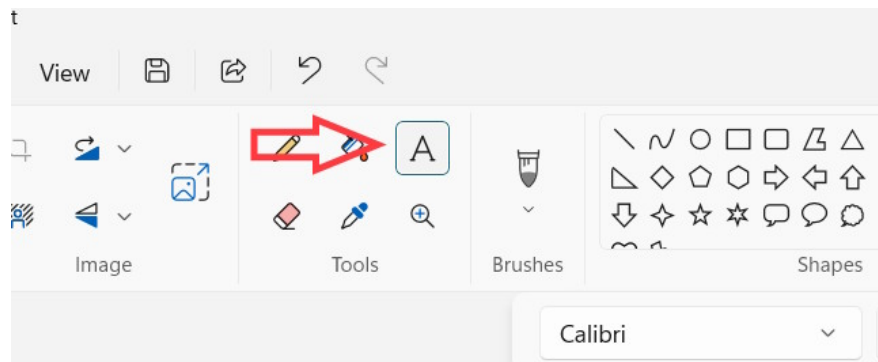

Find the newly added font and select it to use in the Paint application.

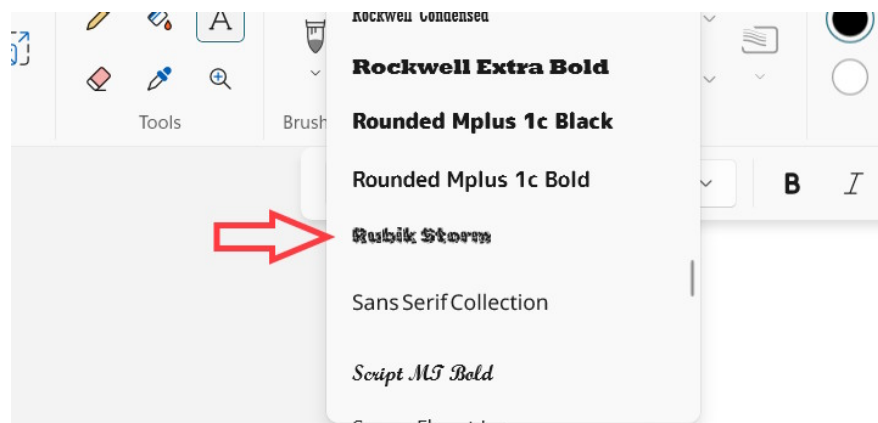

Finally, you write the text in Paint using the font you just used.

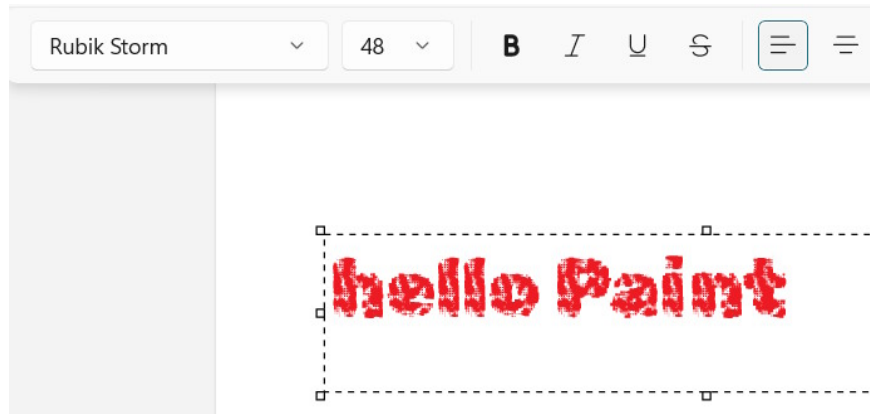

Step 3:

If you want to **delete or uninstall a font** that you imported into the Paint application, you can manually delete that font from the **C:WindowsFonts** folder .

Find the font in this folder and then **click the trash can icon** to delete it.

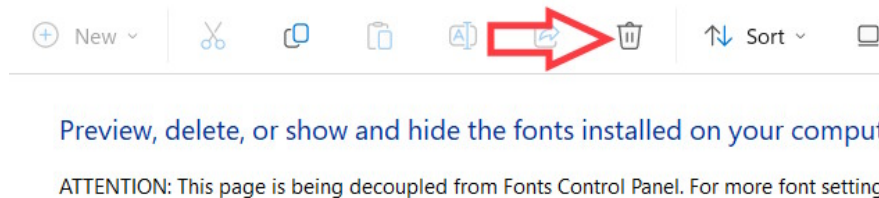

Alternatively, you can go to Settings, select **Personalization > Fonts** to view the system fonts. Then, enter the font you want to delete, **tap the three-dot icon, and select Uninstall** to proceed.

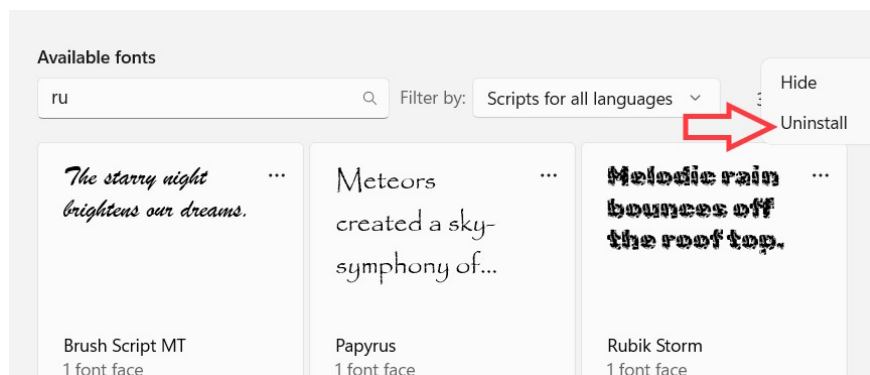

You finished reading the article "**How to add fonts to Microsoft Paint**" edited by the [TipsMake](#) team. We hope this article has provided you with many useful tech tips and tricks. You can search for similar articles on

tips and guides. Thank you for reading and for following us regularly.
