

# Handbook for using YouTube on Android

Many YouTube users on Android only for the purpose of watching videos and subscribe to channels to follow. But you don't know that there are many features on YouTube that you haven't explored yet. Let's see what you've missed.

Many YouTube users on Android only for the purpose of watching videos and subscribe to channels to follow. But you don't know that there are many features on YouTube that you haven't explored yet. Let's see what you've missed.

## Only use wifi to upload videos to YouTube

If you don't want to spend too much mobile data and just want to upload it when connecting to Wifi, you can set up uploading videos to YouTube only when connected to Wifi. Follow these steps:

1. Open **YouTube** from the home screen or app drawer.
2. Touch your avatar in the top right corner of the screen.
3. Click **Settings**.

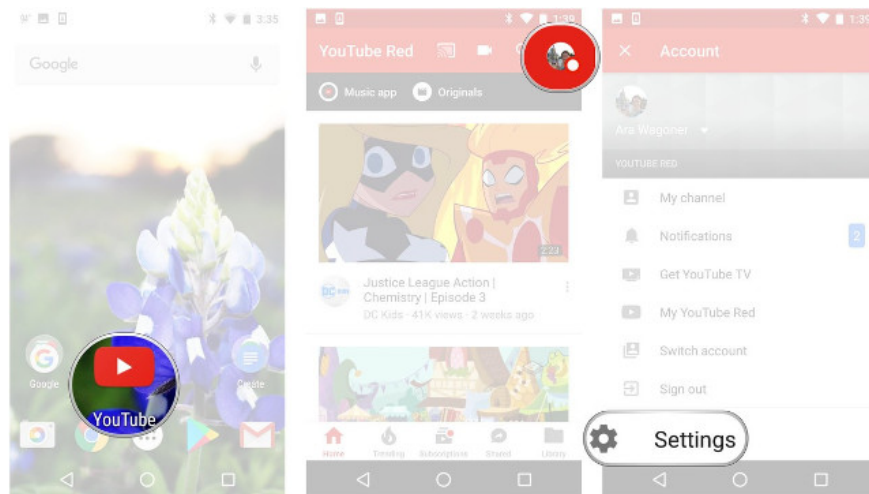

4. Select **General**.
5. Select **Uploads**.
6. Click **Only when on Wi-Fi** or **On any network**.

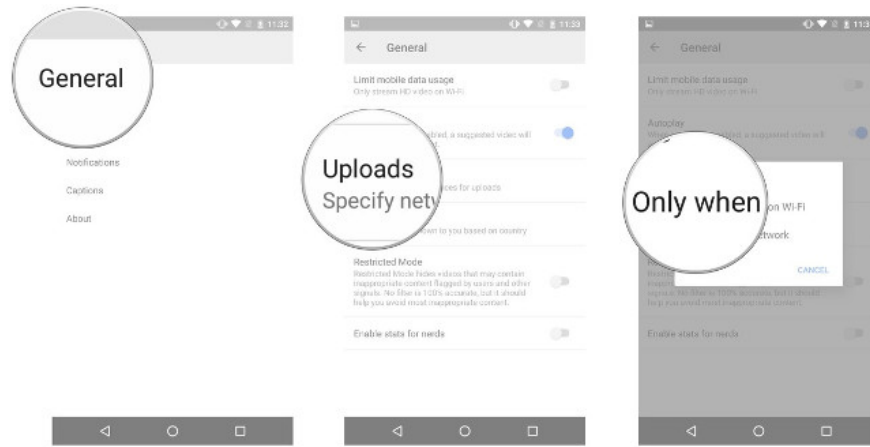

## Limit the use of mobile data

1. Open **YouTube** from the home screen or app drawer.
2. Touch your avatar in the top right corner of the screen.
3. Click **Settings** .

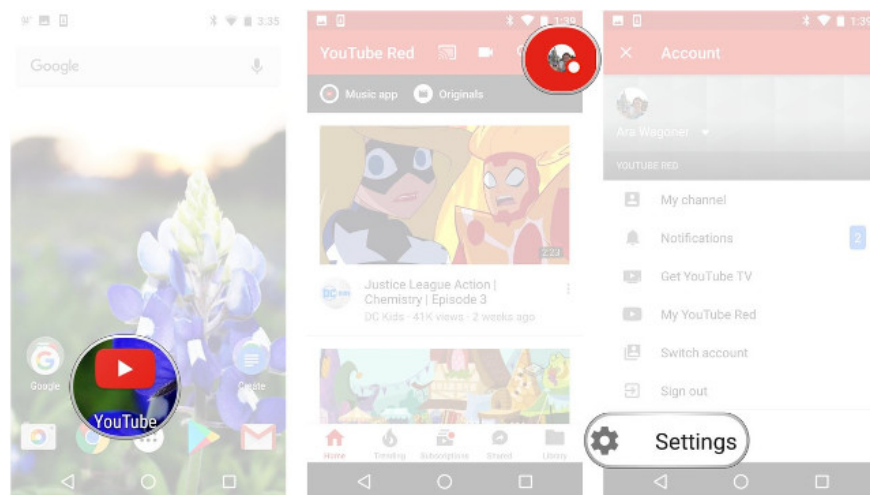

## 4. Select **General**.

5. Turn on the **Limit mobile data usage** feature. This function only allows you to play HD videos when connected to Wi-Fi.

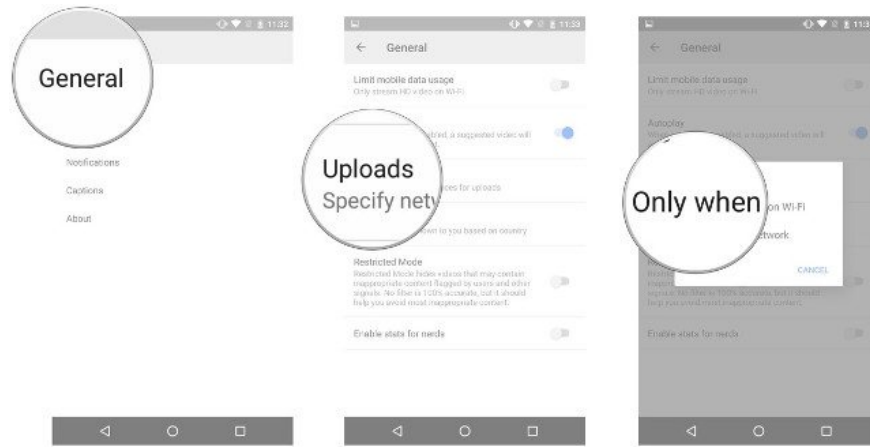

## Notification management

1. Open **YouTube** from the home screen or app drawer.
2. Touch your avatar in the top right corner of the screen.
3. Select **Settings**. Do not click on Notifications here because these are just your current announcements.
4. Then in the **Settings** section select **Notifications**.

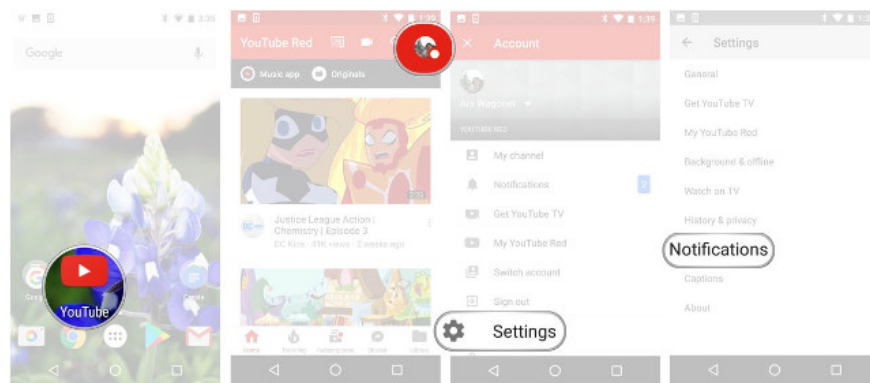

5. In **Notifications**, select the notification settings options you want to disable.
6. Select **Subscriptions: Notify me via**.
7. Then choose **Push and email**, **Push only**, or **Email only**

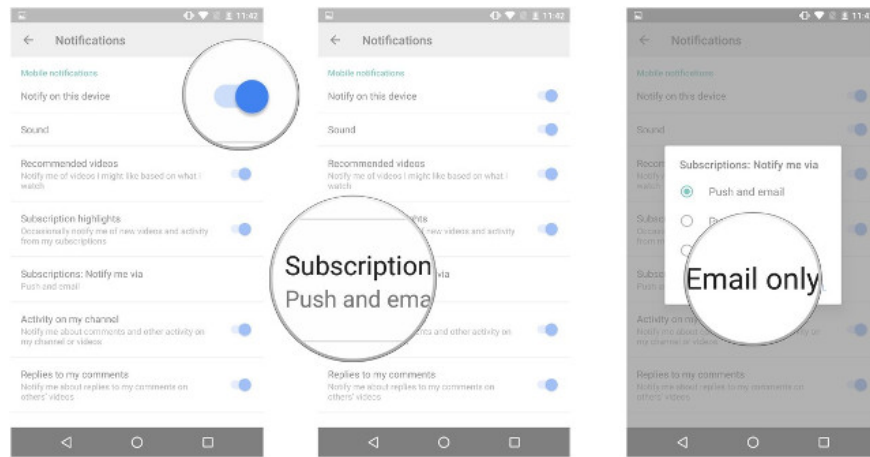

## Disable automatic video playback

1. Open **YouTube** from the home screen or app drawer.
2. Touch your avatar in the top right corner of the screen.
3. Click **Settings** .

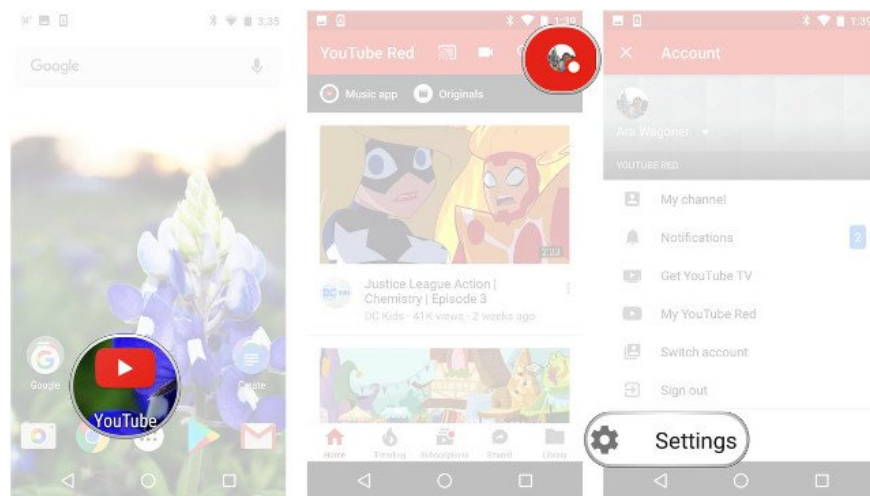

4. Select **General** .
5. Turn off **Autoplaymode**.

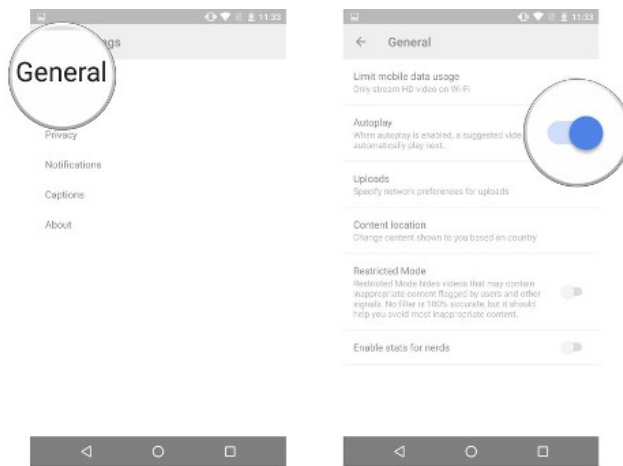

## Turn on / off restriction mode

Restricted mode is a way to filter content that is considered inappropriate for children. However, this feature may be a bit annoying if you like to read comments that are hidden by default.

1. Open **YouTube** from the home screen or app drawer.
2. Touch your avatar in the top right corner of the screen.
3. Click **Settings**.

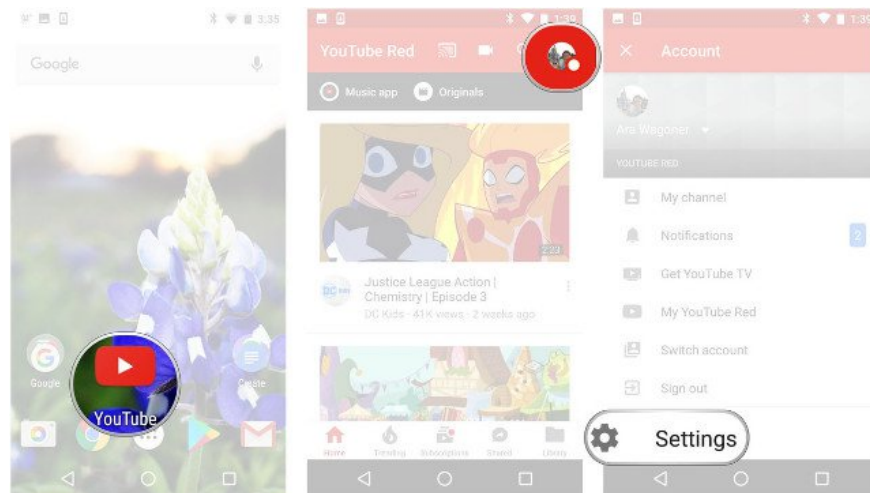

4. Select **General**.
5. Select **Restricted Mode** to turn on / off.

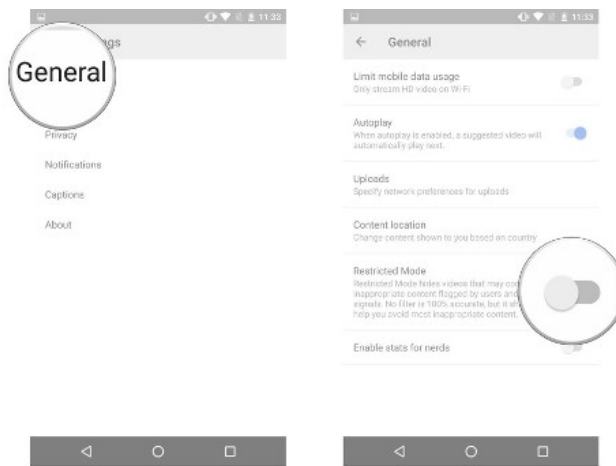

## Change content location

You will not be able to view locked content in the area because it is highly relevant to your Google account and other factors, but you can change the videos recommended for you, as well as ads. you see.

1. Open **YouTube** from the home screen or app drawer.
2. Touch your avatar in the top right corner of the screen.
3. Click **Settings**.

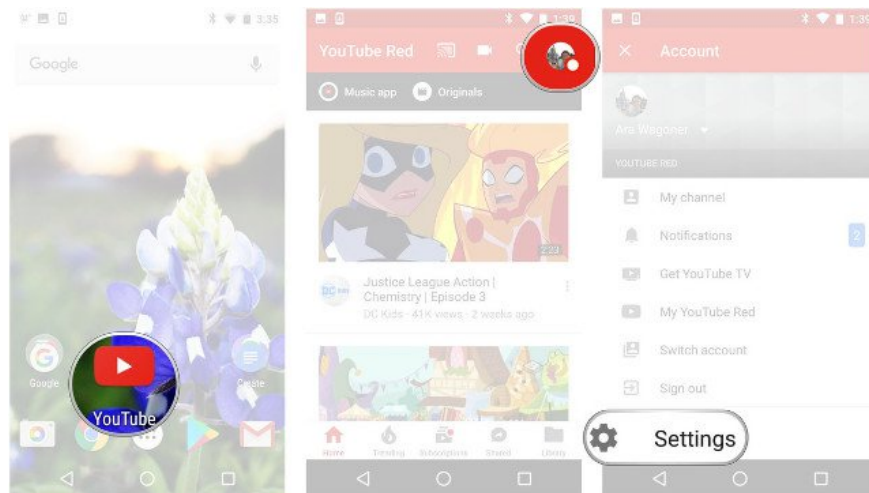

4. Select **General**.
5. Click **Content location**.
6. Select an area in the **region**.

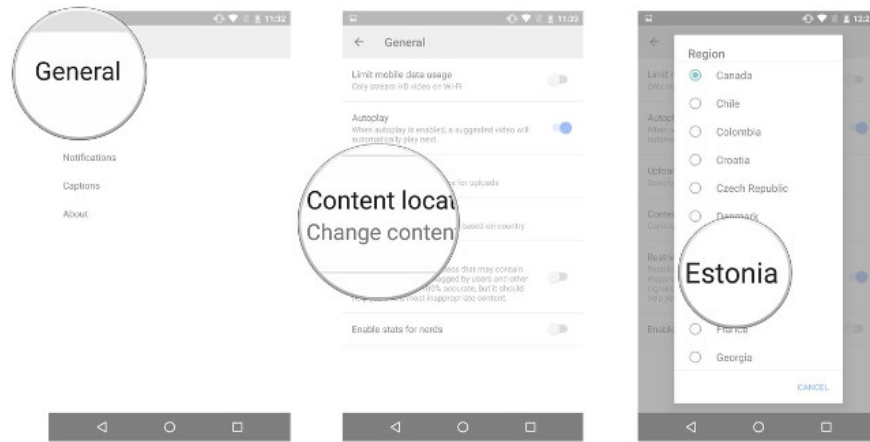

You finished reading the article "**Handbook for using YouTube on Android**" edited by the [TipsMake](#) team. We hope this article has provided you with many useful tech tips and tricks. You can search for similar articles on tips and guides. Thank you for reading and for following us regularly.

---