

Enable Multi Window on Android 6.0

The Marshmallow version of Android is integrated with some outstanding new features, including multitasking window - Multi Window Mode. Although this feature has been built into Android source code, there is no option to enable the feature at Settings or other sections.

The Marshmallow version of Android is integrated with some outstanding new features, including **multitasking window** - Multi Window Mode. Although this feature has been built into Android source code, there is no option to enable the feature at Settings or other sections.

The Multi Window feature allows you **to use two applications at the same time** . This feature has been disabled by Google because the use of this feature may malfunction or cause unnecessary errors.

In the following article, Network Administrator will guide you how to **enable Multi Window on Android 6.0** .

1. Enable Multi Window hidden on Android Marshmallow

To enable the Multi Window feature hidden on Android Marshmallow, follow the steps below:

Step 1:

First, make sure your Android device is **rooted** .



Step 2:

Next download and install **Root Explorer** from **Google Play Store** .

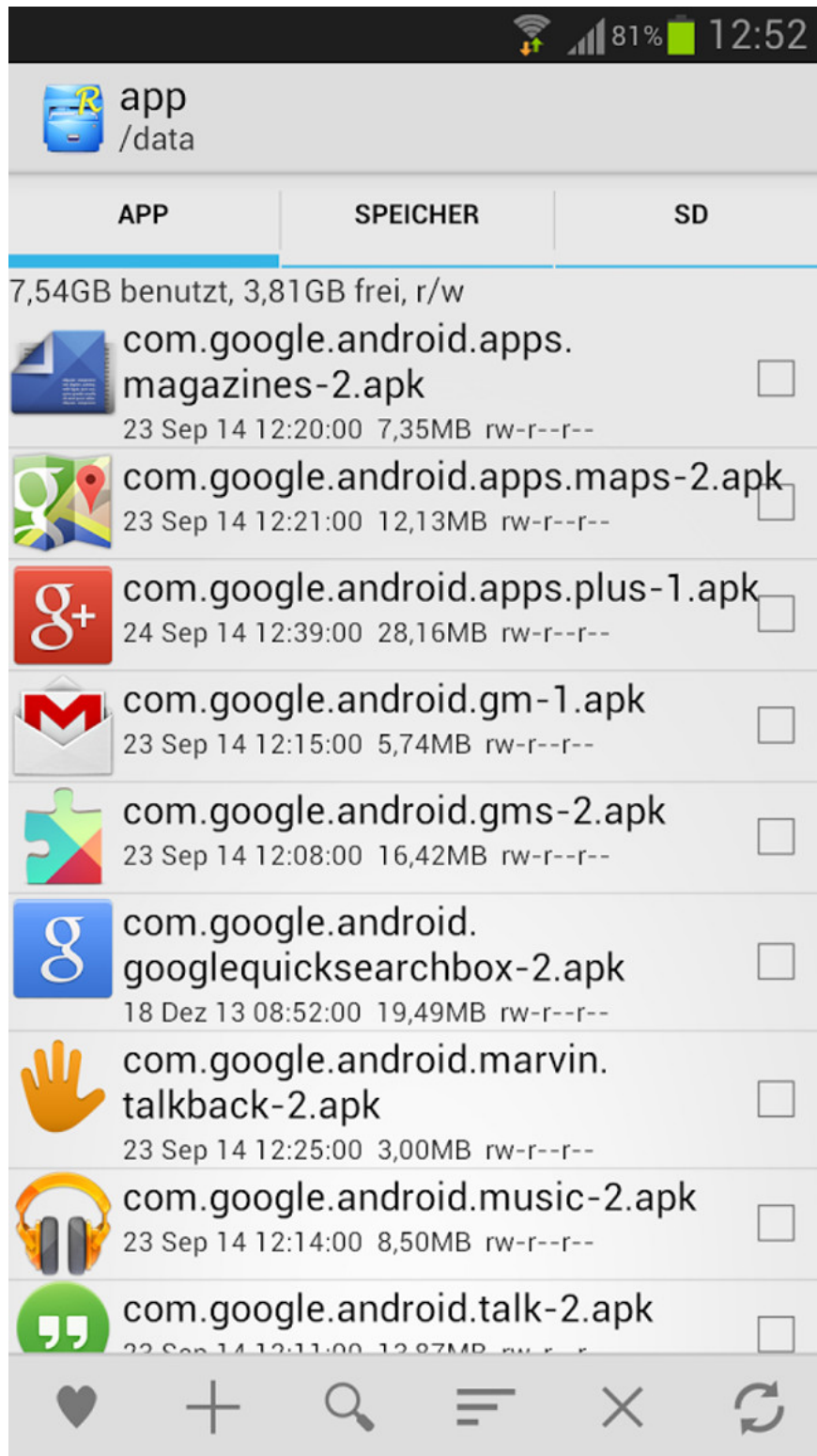

Step 3:

Open **Root Explorer** and navigate to **directory / system /**.



Step 4:

In the **System** window, find and click the file named **build.prop** to open the file. Here you change the build type value from **user** to **userdebug** .

```
build.prop
# begin build properties
# autogenerated by buildinfo.sh
ro.build.id=JZ054K
ro.build.display.id=The Mother Of All Roms
ro.build.version.incremental=L710VPBMA4
ro.build.version.sdk=16
ro.build.version.codename=REL
ro.build.version.release=4.1.2
ro.build.date=Sat Jan 19 23:59:58 KST 2013
ro.build.date.utc=1358607598
ro.build.type=user
ro.build.user=se.infra
ro.build.host=SEP-97
ro.build.tags=release-keys
ro.product.model=SPH-L710
ro.product.brand=samsung
ro.product.name=d2spr
ro.product.device=d2spr
ro.product.board=MSM8960
ro.chipname=MSM8960
ro.product.cpu.abi=armeabi-v7a
ro.product.cpu.abi2=armeabi
ro.product_ship=true
ro.product.manufacturer=samsung
ro.product.locale.language=en
ro.product.locale.region=GB
ro.wifi.channels=
ro.board.platform=msm8960
# ro.build.product is obsolete; use ro.product.device
ro.build.product=d2spr
# Do not try to parse ro.build.description or .fingerprint
ro.build.description=d2spr-user 4.1.2 JZ054K
```

Step 5:

Save the file and restart your Android device to apply changes.

Step 6:

The next step you need to do is **activate Developer Mode** . To enable this mode, you access **Settings => About phone => Build number** (press the option 7-10 times to activate the Developer option).

After activating Developer Mode, go to **Settings => Developer Options** and activate the **Multi-window** option.

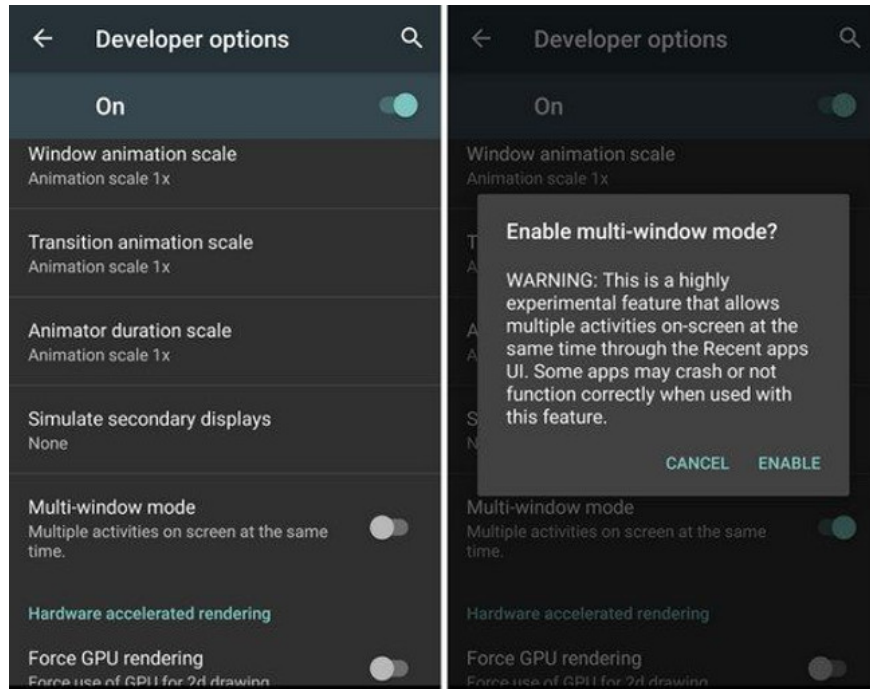

2. Use Build Prop Editor

The simpler way to enable Multi-windows feature on Android 6.0 is to edit **Build.Prop** or **property files** on Android device.

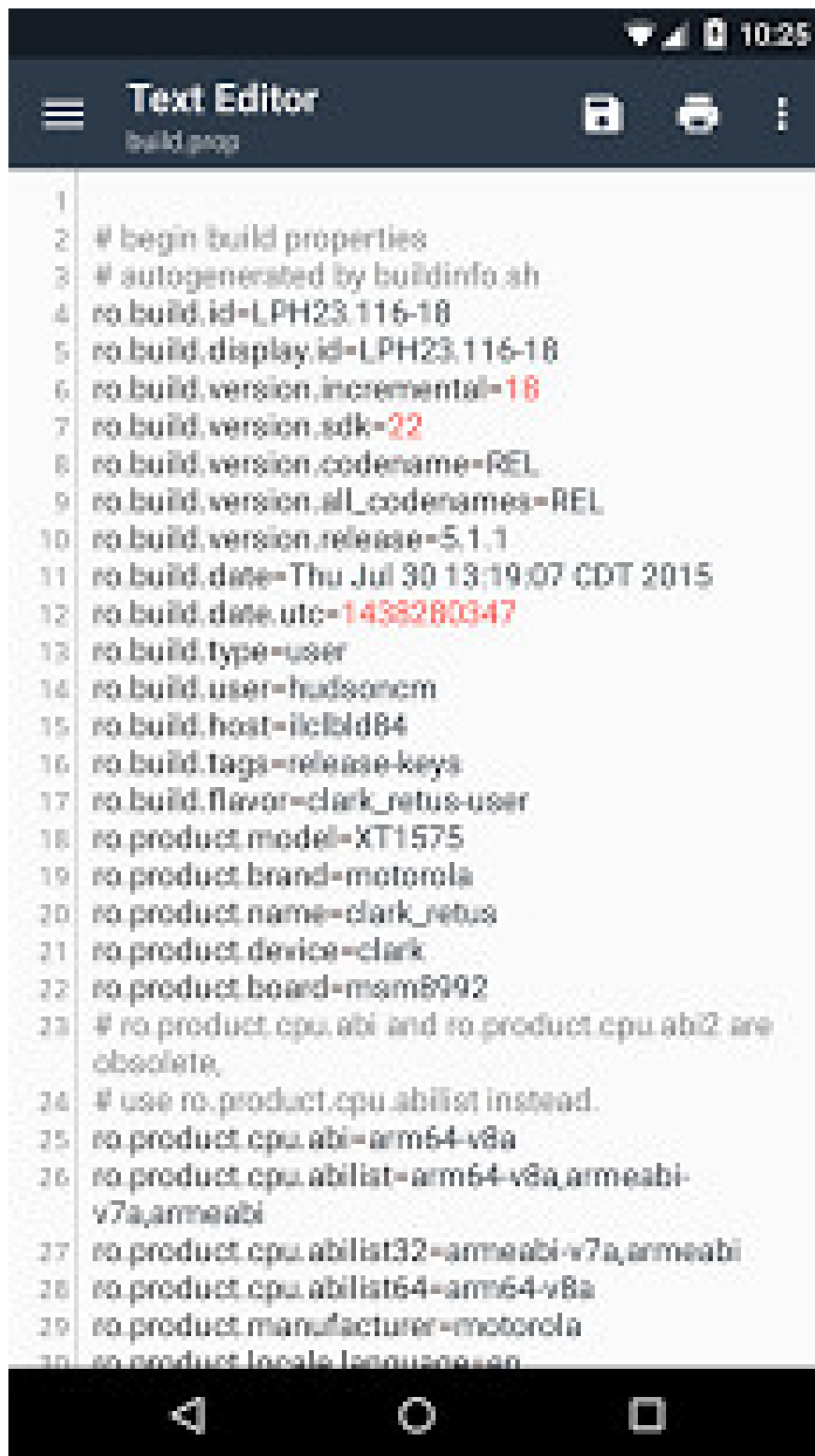
A screenshot of a mobile text editor application titled "Text Editor" showing the contents of a file named "build.prop". The editor interface includes a dark header with a hamburger menu icon, the title "Text Editor", and icons for save, print, and a vertical ellipsis. The status bar at the top shows signal strength, Wi-Fi, battery, and the time 10:25. The code is displayed on a light background with line numbers from 1 to 30 on the left. The code contains various system properties for a Motorola XT1575 device, including build information, user details, and product specifications. The value for "ro.build.type" is currently set to "user".

```
1
2 # begin build properties
3 # autogenerated by buildinfo.sh
4 ro.build.id=LPH23.116-18
5 ro.build.display.id=LPH23.116-18
6 ro.build.version.incremental=18
7 ro.build.version.sdk=22
8 ro.build.version.codename=REL
9 ro.build.version.all_codenames=REL
10 ro.build.version.release=5.1.1
11 ro.build.date=Thu Jul 30 13:19:07 CDT 2015
12 ro.build.date.utc=1438280347
13 ro.build.type=user
14 ro.build.user=hadsoncm
15 ro.build.host=iclbld84
16 ro.build.tags=release-keys
17 ro.build.flavor=clark_retus-user
18 ro.product.model=XT1575
19 ro.product.brand=motorola
20 ro.product.name=clark_retus
21 ro.product.device=clark
22 ro.product.board=mam8992
23 # ro.product.cpu.abi and ro.product.cpu.abi2 are
   obsolete,
24 # use ro.product.cpu.abi2 instead.
25 ro.product.cpu.abi=arm64-v8a
26 ro.product.cpu.abi2=arm64-v8a,armeabi-
   v7a,armeabi
27 ro.product.cpu.abi32=armeabi-v7a,armeabi
28 ro.product.cpu.abi64=arm64-v8a
29 ro.product.manufacturer=motorola
30 ro.product.locale.language=en
```

Step 1:

First you need to download and install Build Prop Editor on your rooted Android device, then open **Build Prop Editor** and find **ro.build.type** , edit the **Property Value** from **User** to **userdebug** .

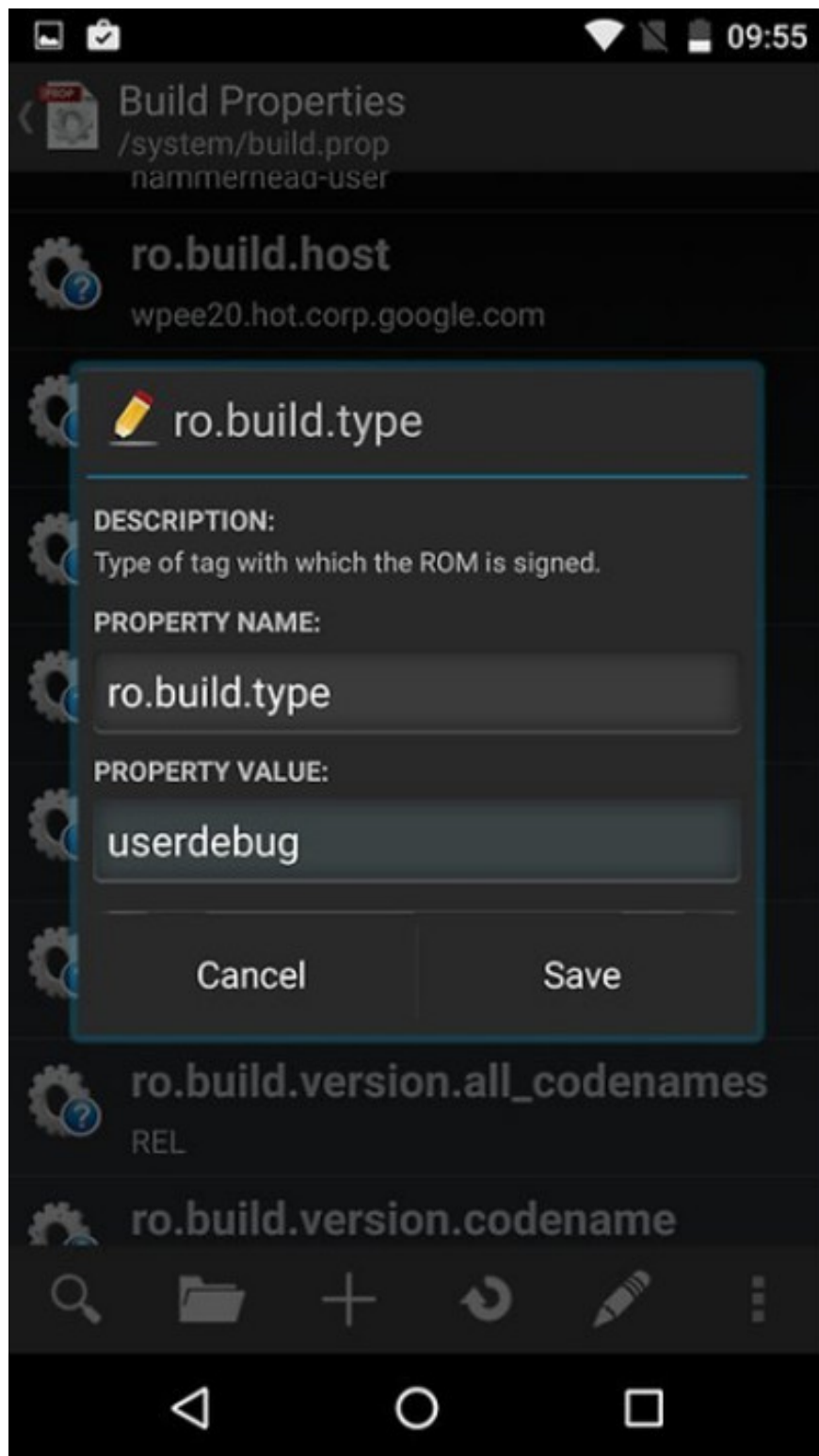

Step 2:

Next **save the** changes and you will be asked to restart your device.

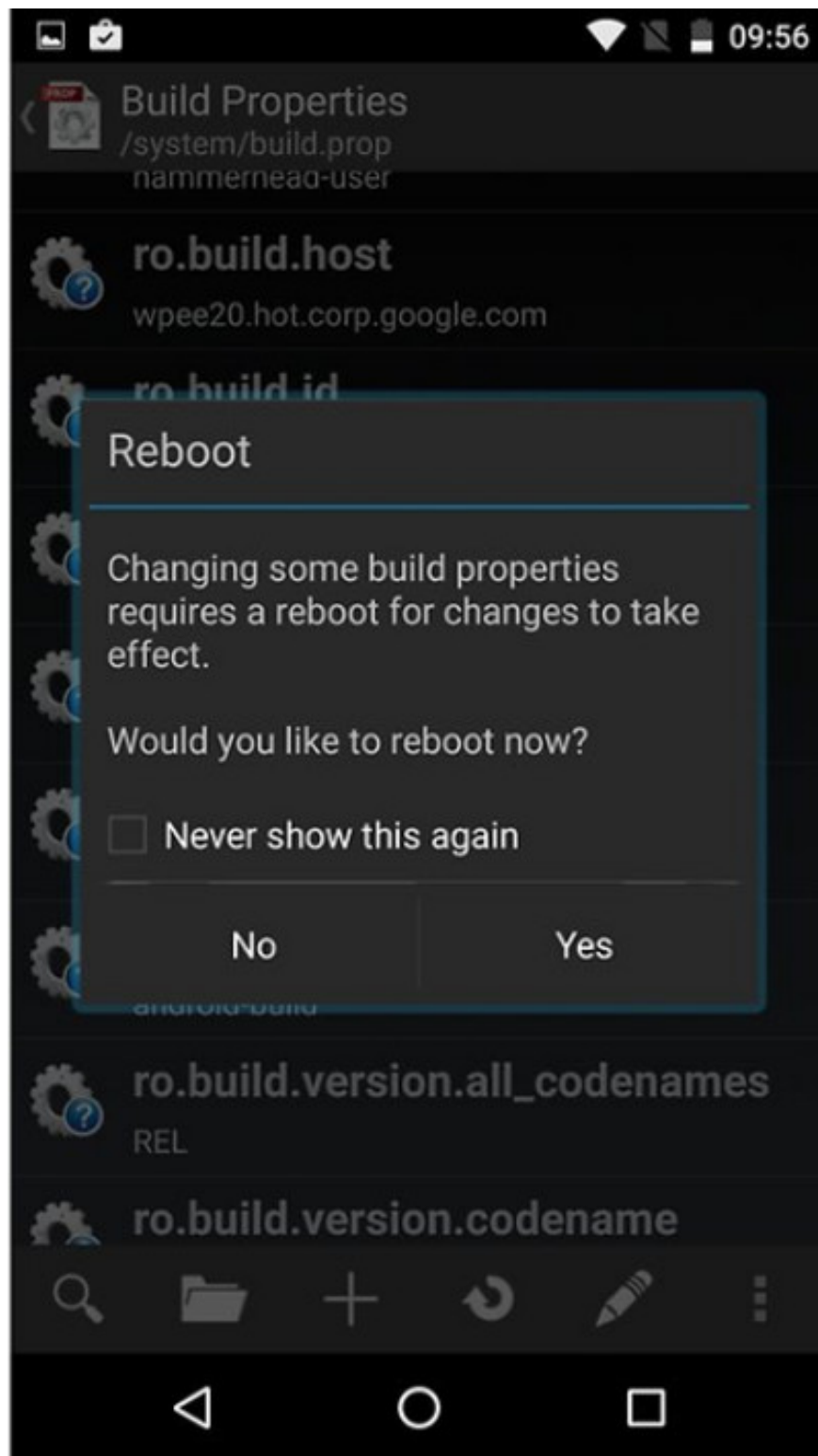

Step 3:

After your Android device has finished booting, go to **Settings => Developer option** .

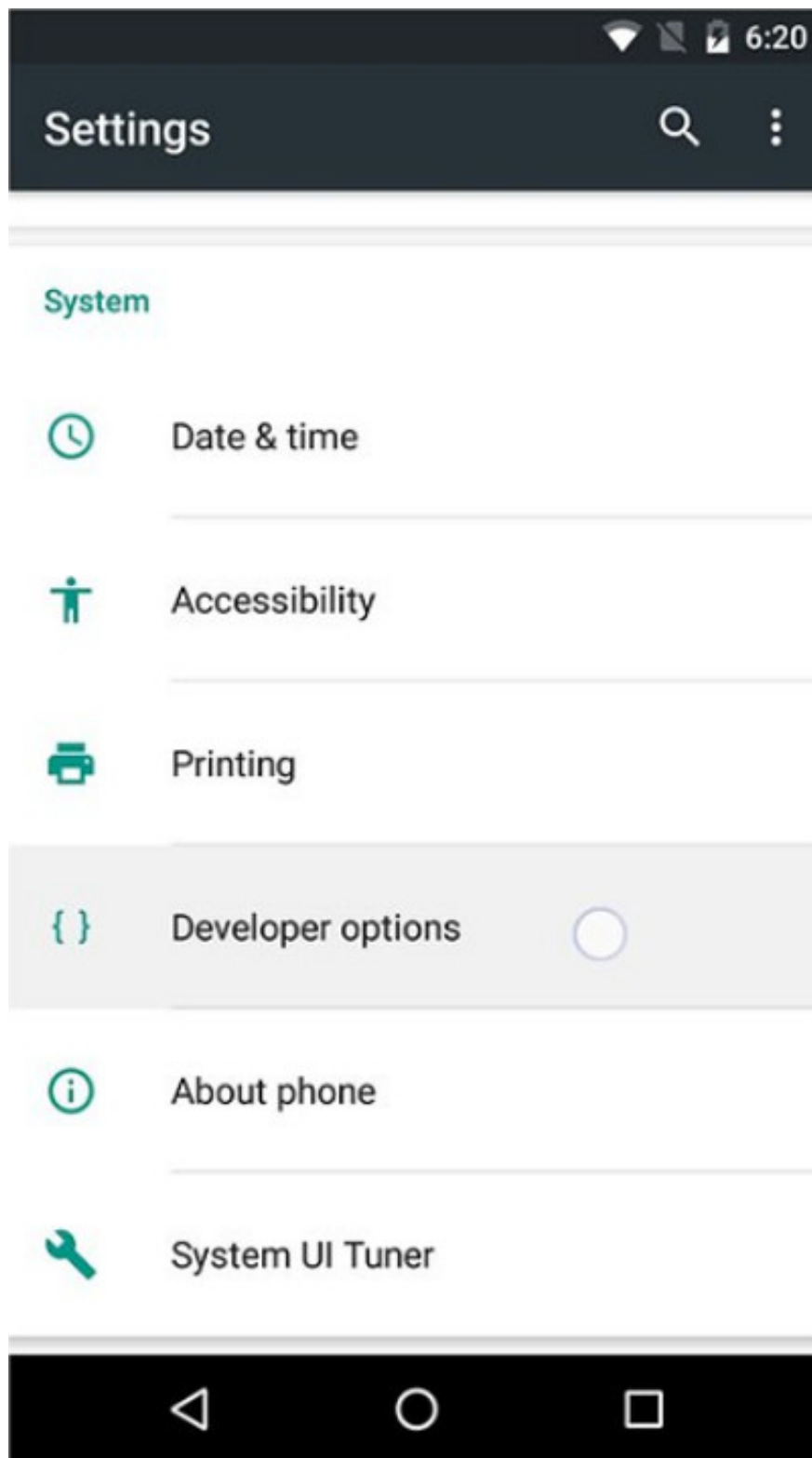

Step 4:

Finally find and switch the optional state **Multi-window mode** to **ON**.

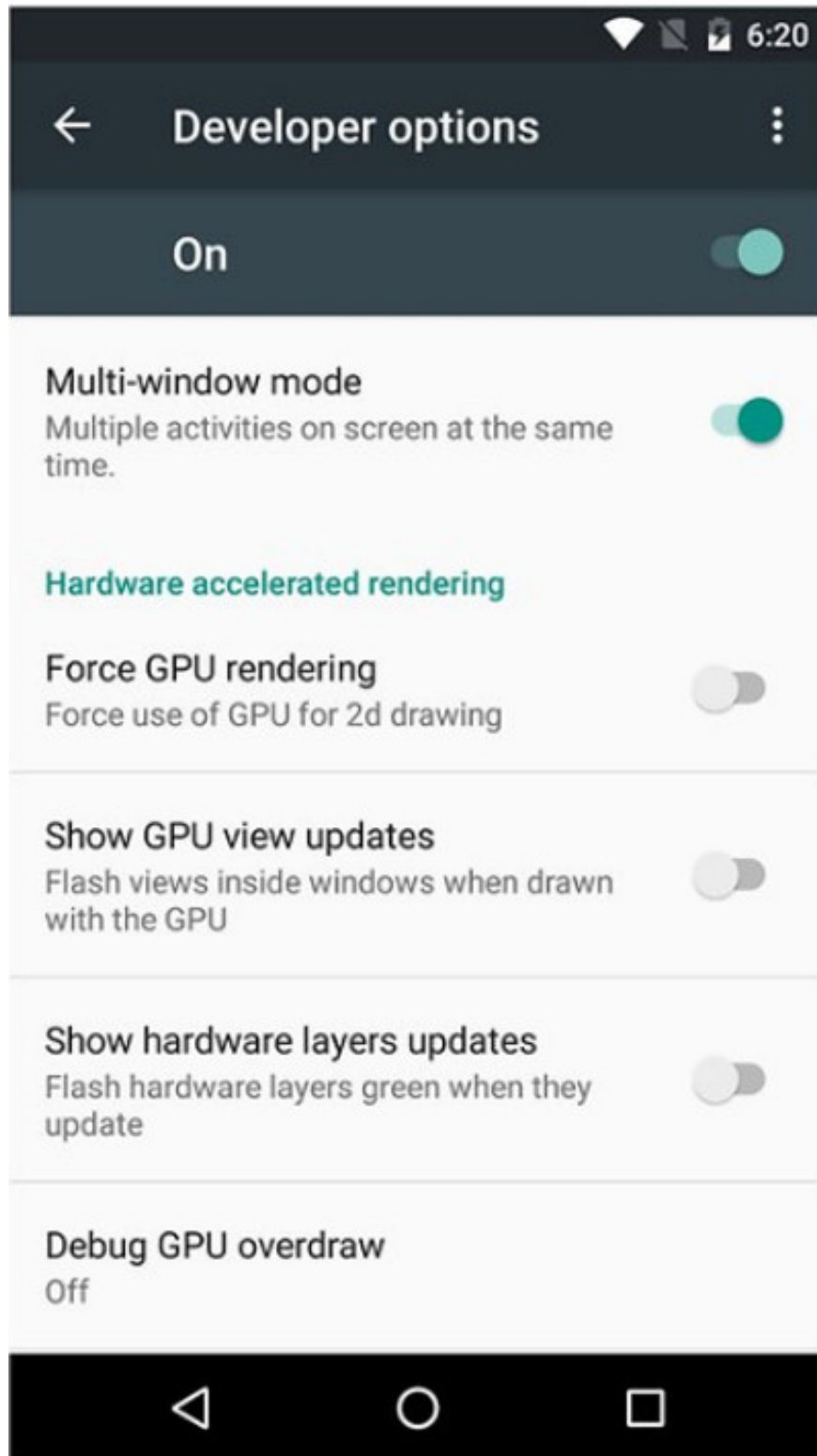

Refer to some of the following articles:

1. This is a way to transfer files from your computer to your Android phone without a USB cable
1. All problems about how to install and use Google Duo video calling application

1. Instructions for controlling Android devices via computer

Good luck!

You finished reading the article "**Enable Multi Window on Android 6.0**" edited by the [TipsMake](#) team. We hope this article has provided you with many useful tech tips and tricks. You can search for similar articles on tips and guides. Thank you for reading and for following us regularly.
