

Enable and disable some of Gmail's new features

The article will show you how to turn on / off new tabs in inbox, Gmail's full-screen email window.

The article will show you how to turn on / off new tabs in inbox, Gmail's full-screen email window.

Turn on / off new tabs in the inbox

In May 2013, Google launched the latest attempt to help Gmail users manage their emails - redesigned inbox.

New inbox categorizes incoming emails into multiple tabs. The most important emails will 'flow' into the Primary tab, while social network notifications from sites like Google+ will be grouped under the Social tab. Email notifying transactions from websites such as Groupon goes to the Promotions tab, while emailing the receipt / confirmation goes to the Updates tab. The Forums tab contains emails of online discussion groups, mailing lists .

If you haven't seen tabs when signing in to Gmail (*in a web browser*) or you want to change your settings, do the following:

1. Click the plus sign (+) in the middle of the interface that appears when logging in to Gmail (*or click the gear icon on the right> select Settings> click Inbox*).

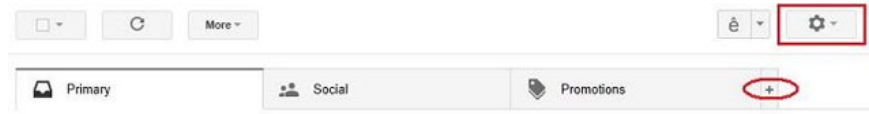

How to customize Gmail's tabs.

2. Now select which of the 5 available tabs you want to enable, or disable. To better understand each tab, just hover your mouse over the name of that tab> Gmail will show you the information.

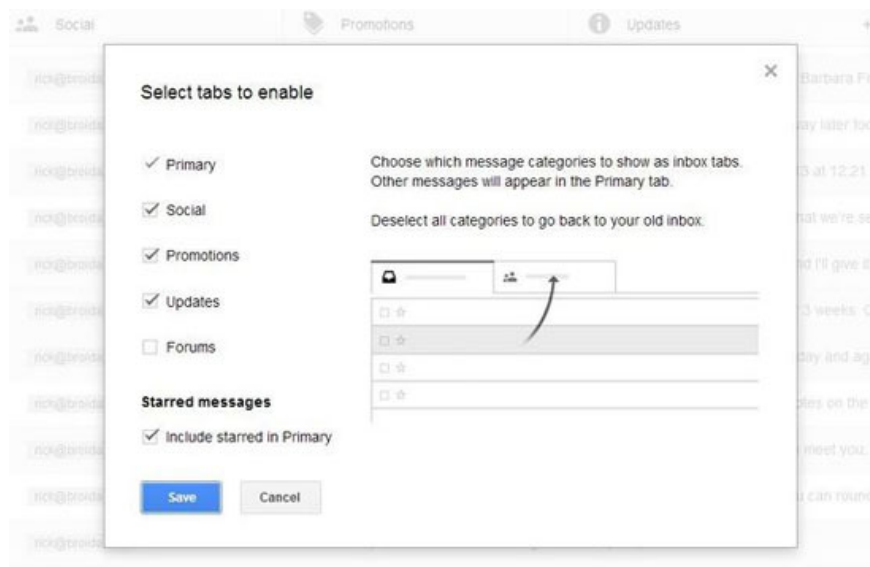

Gmail tabs.

4. Once you have made your selection, click **Save** .

Currently, Gmail does not yet provide a way to customize tabs or add new tabs. Moreover, if you activate any tab> you will lose the old Inbox Priority interface.

Turn on / off full screen window of email writing.

By default, when you click **Gmail's Compose** button> a window will appear in the right corner of the screen.

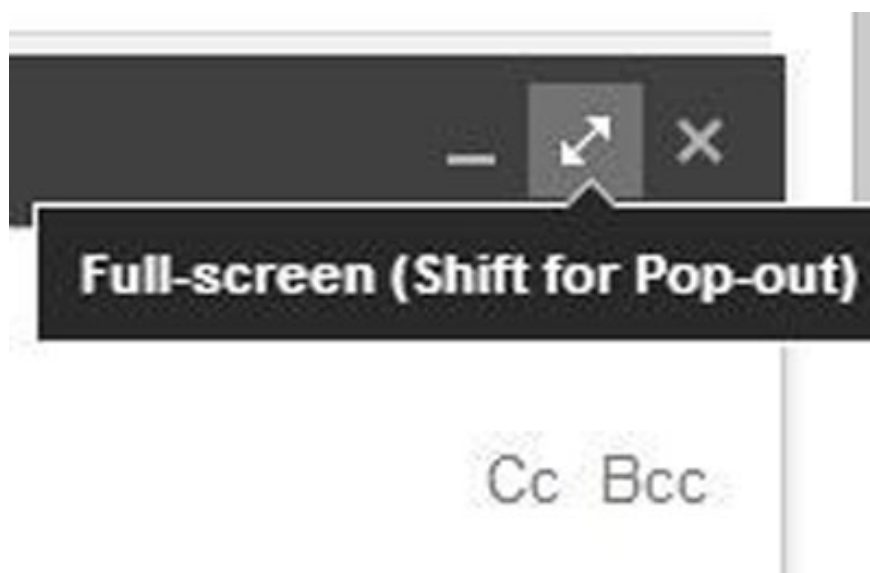

Now, in the upper right corner of that Compose window, you will see 3 icons: *Minimize (Minimize)* , *Full screen (Full-screen)* and close (*Close*). Clicking the icon in the middle will enlarge the window, although the " *full screen* " description is not really true. This window is in the center of the screen with the background dark.

Want the Compose window in full screen mode by default, do the following:

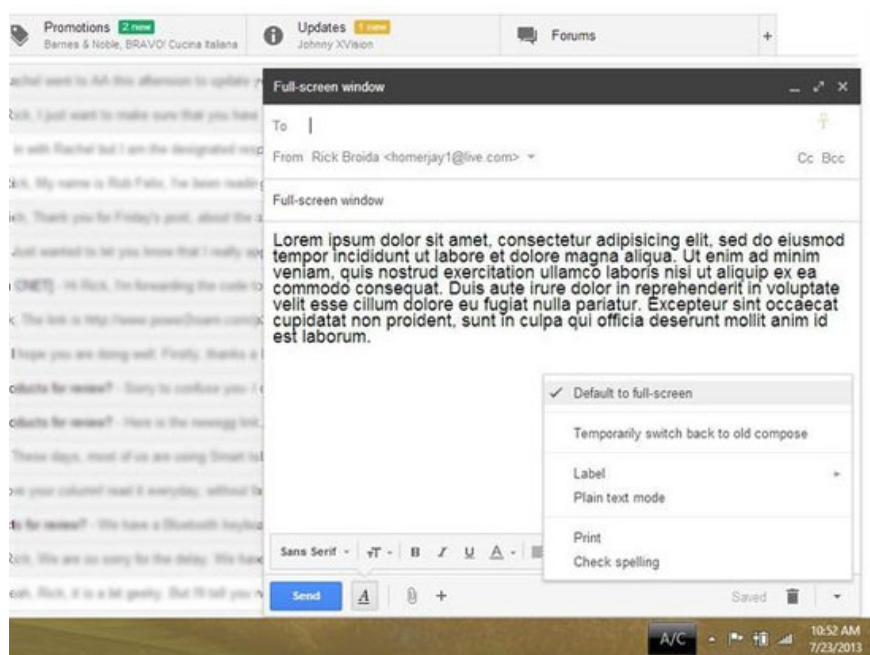

1. After clicking **Compose** , find the small arrow in the lower right corner of the Compose window.
2. Click the **arrow** > select **Default to full-screen** .

It's done. If you bend the Compose window back to the small screen mode, repeat this process.

You finished reading the article "**Enable and disable some of Gmail's new features**" edited by the [TipsMake](#) team. We hope this article has provided you with many useful tech tips and tricks. You can search for similar articles on tips and guides. Thank you for reading and for following us regularly.