

Chrome adds AI features that make common tasks easier

So far, Google Chrome has launched 3 Generative AI features and many more Gemini integration features were introduced this year.

So far, Google Chrome has launched 3 Generative AI features and many more Gemini integration features were introduced this year.

Adriana Porter Felt, director of engineering at Chrome, said: *'We're thinking about how to bring AI technology into the browser to do the typical actions you do every day - tabbing, searching, writing forms, reading web pages - a little easier'. 'We've gathered ideas from the entire Chrome team'.*

"When we think about the future of Chrome, we just think: 'How can we make it as useful as possible?'" said director Adriana .

Of those four common tasks, the current feature set does not address *'using the search function'* or *'reading a web page'* . "Read website" can summarize articles, while "use search function" can integrate with SGE. The Chrome address bar has just added the *@Gemini* shortcut to quickly access *gemini.google.com*.

The process of developing LLM-powered features involves taking the platform model and *'teaching it what we want to do for example use cases and then evaluating how it performs with a variety of scenarios. different users'*

Google launched its 'Sort Similar Tabs' feature in January, with a tab organizer that uses emojis to make it easier to scan those groups. One concern is making sure Chrome doesn't pick up something inappropriate:

With help from the emoji team, Google has outlined which types of tab group categories are safe for widespread use. Director Adriana says: *'Travel, animals, places, nature are great use cases for emojis, so we knew the automatic tab organizer had a chance of doing it right by based on those categories'* .

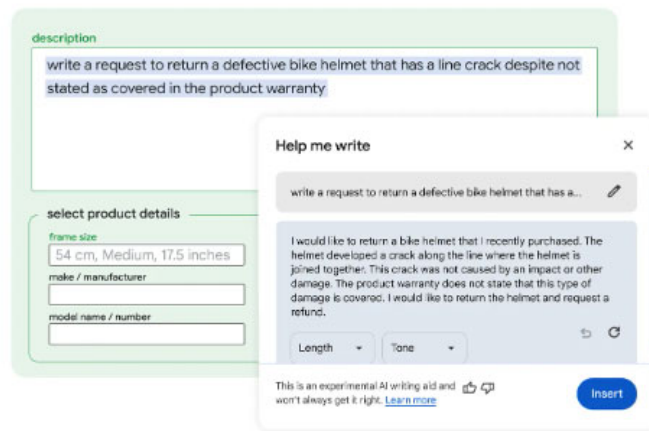
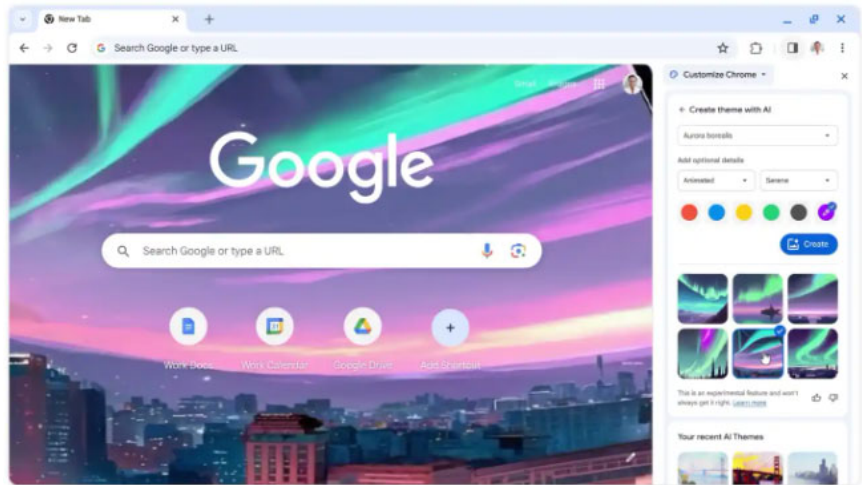
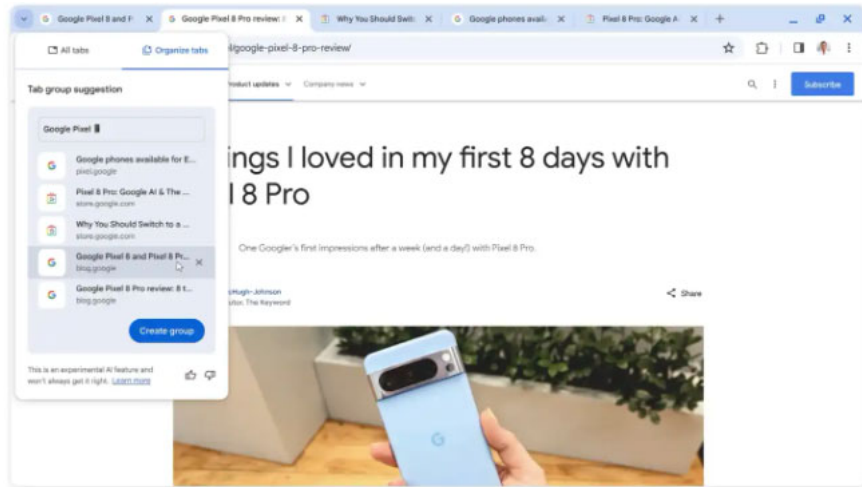

Meanwhile, the theme generator did not accept the open prompt as originally planned after realizing that *'it was really difficult to give a prompt for this'*. Instead, like on Android, the tool offers various drop-down menus: Subject, Style, and Mood. In this case, the 'narrower option' will give better results, while also ensuring that it is not used as a generic text-to-image tool.

Finally, Help me write will first gather context about the website: *'It can see you want to write a restaurant review and tailor that instead of helping you fill out a form or sell something'*.

You finished reading the article "**Chrome adds AI features that make common tasks easier**" edited by the [TipsMake](#) team. We hope this article has provided you with many useful tech tips and tricks. You can search for similar articles on tips and guides. Thank you for reading and for following us regularly.
