

Are there ways to connect your phone to a TV to watch videos?

With today's modern technology, the number of TVs that can watch videos is increasingly popular. Depending on the particularity of each television line, they have different ways of connecting. So can your home TV see the video and in what ways? Please refer to this article for more useful information.

It's not too hard to find a TV with a plug to watch video on the market today. In each television series, they are equipped with plugs or more modern with smart TVs that can connect to the Internet and show every video. So which TV family do you belong to and how can you watch videos? The following article will help you answer that question.

1. Learn more about TV resolution

A. Use physical connection

Phones are growing, many phones are packed with the power of a computer. As a result, many smartphones offer spectacular multitasking capabilities from video streams to games and music, all from mobile devices.

Although the phone's built-in screen is convenient for moving, when you want to watch high-definition video and images, this is an obstacle. Therefore, smartphone users always learn how to connect the phone to the TV for a more enjoyable experience on the big screen. This article will show you how to connect your phone to a TV using USB.

1. 8 ways to project your phone screen on a television

Why use USB to connect phones and tablets to TV?

With many ways to project your phone screen on TV like using wireless, software, etc. surely many people will wonder why using USB to connect the phone to the TV. If you connect your phone to the TV using a fixed connection, you will receive a low latency signal. For example, if you plan to show your phone on a TV to play games, you will need a USB connection instead of a wireless configuration, as it will reduce latency.

1. How to transfer photos from iPhone to a TV without a cable

How to connect your phone and tablet to a TV with USB

When using a wired connection from phone to TV, you have several options. The method you use will depend on your specific operating system and device and how the connection will be different on iPhone and Android phones.



Similarly, the connection method also varies depending on your needs. For example, for the purpose of viewing photos on a compatible TV, you only need a charging cable and a mobile device, but if you want to project the screen, you need a USB adapter. Here are some ways to connect your phone to a TV using USB, choose a method that suits your needs.

Connect your Android phone to the TV using MHL

MHL is one of the most popular solutions for connecting a phone to a TV with a USB cable. This technology, short for Mobile High-Definition Link, allows MHL-compatible devices such as smartphones and tablets to connect to TVs and projectors. You can see a list of MHL-supported devices on MHL's official website.

Necessary equipment:

1. Phone supports MHL
2. Adapter or cable MHL USB to HDMI
3. Monitor with HDMI input
4. HDMI cable
5. Power cable

Although this is a general setup, you need to change the specific cable for each device, search Google with the MHL cable [your device name] syntax to find a list of compatible cables.



To connect the USB to the TV with MHL, first connect your phone via MHL adapter. The adapter will require power from the USB port on the cable or external power. Samsung MHL adapter has a micro-USB port on the side that can be used with most cables. Some cables come with connectors for phones or tablets and power in one device.

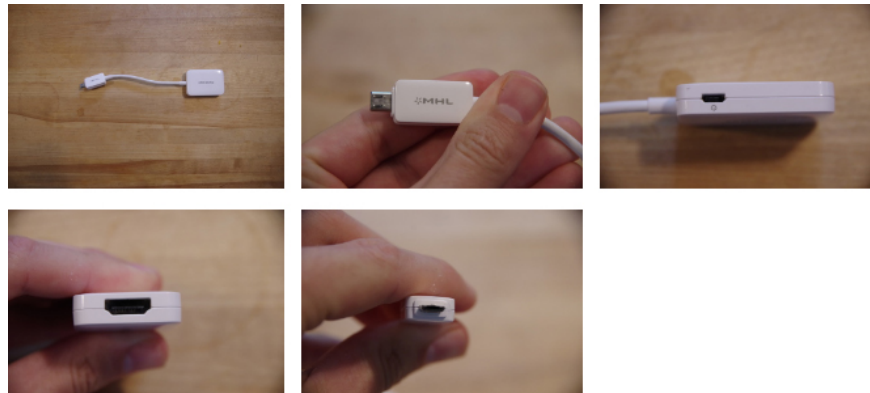

Next, connect your phone to the TV with an MHL cable. After that, you will see the phone screen on the TV. In general, MHL is one of the best solutions for connecting an Android phone to a TV with a USB cable.

1. Ways to connect Android phones to Samsung TVs

Connect your Android phone to your TV using SlimPort

In addition, you can connect your phone to a TV with a SlimPort cable. Because both MHL and SlimPort are technologies for distributing content from mobile devices to monitors with physical connections, they are the same. However, SlimPort differs in its outputs.

While MHL is limited to HDMI video output, SlimPort can send signals via HDMI, DVI, DisplayPort and VGA. As such, this method is more suitable for many monitors including old screens and TVs with VGA but without digital inputs.

In addition, MHL and SlimPort power supplies are also different. Although MHL initially requires a power connection, this is not necessary with MHL 2.0. MHL takes power from a mobile device, ideal for connecting power cables, however, SlimPort does not get power from mobile devices.

You will need the following devices to connect your phone to the TV using SlimPort adapter:

1. SlimPort-compatible phone (list of supported SlimPort devices)
2. SlimPort cable or adapter
3. Video cable (HDMI, DVI, DisplayPort or VGA)
4. Monitor with HDMI, DVI, DisplayPort or VGA input

Just like using MHL, the SlimPort cable you use depends on your device. To connect, first plug SlimPort adapter into the phone, then attach the SlimPort adapter to the screen using the appropriate cable.

Connect your Android tablet to the TV with a USB cable

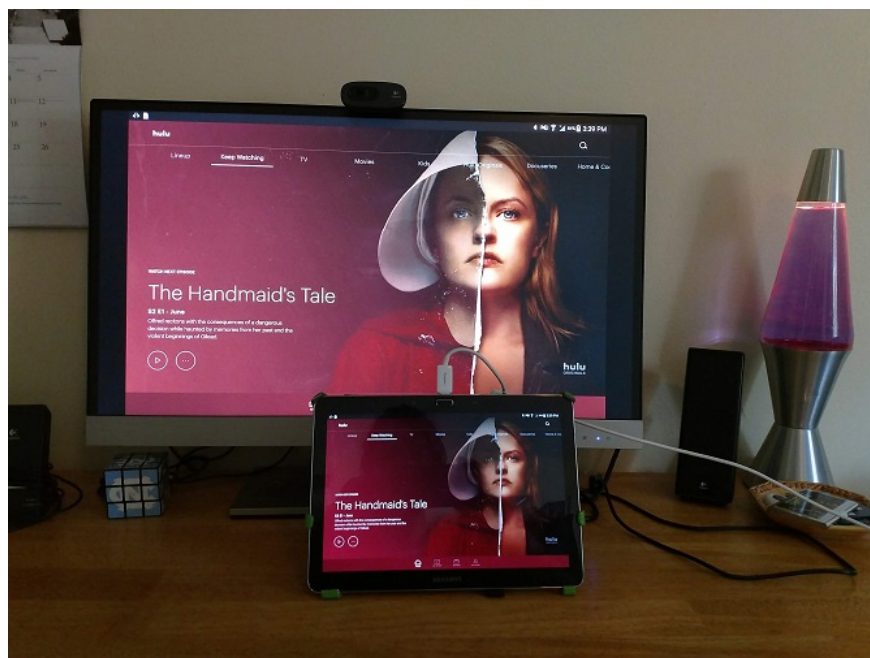

You can also connect the tablet to the TV using a USB cable. For compatible Android tablets, you will use MHL or SlimPort. This process is the same as connecting a phone to a TV. Ideally, you should use a phone and tablet that is compatible with MHL or SlimPort, so you can use one adapter for both devices.

How to connect iPhone to TV using USB

Connect your iPhone to the TV similar to connecting an Android device, but you will need another cable. Modern iPhones (iPhone 5 and above) are equipped with Lightning connectors. You will need the Lightning digital AV adapter for HDMI output, or Lightning to VGA adapter if a VGA connection is required. IOS devices with an old 30-pin port will use a 30-pin VGA adapter.

After plugging in the adapter, you just need to attach the video output to the screen and your phone screen will be projected on the TV. Apple's official Lightning adapter has an additional Lightning port for charging while watching content on the second screen.

How to connect iPad to TV with USB

Like connecting iPhone to TV with USB, you can connect iPad with one device. Similar to the above you will need a Lightning cable to make the connection. Only the iPad 3 and earlier used a 30-pin cable, the remaining iPads such as the iPad Mini and iPad Pro all use Lightning cables. In addition, you will choose Digital AV adapter or VGA adapter depending on the screen input.

Connect to storage device



Although the most common way to connect your device to a TV with USB is to mirror the screen, but there is another option. Instead of projecting the screen, you can also only view files as images on the TV. However, you will need a compatible monitor, TV or projector.

Among the USB connections to different TVs, this is the easiest way because it only requires the phone, USB cable and TV with USB input, so the setup is simple. Which specific cable you need will depend on your phone.

On iPhone or iPad, you will use Lightning cable (or 30 pins for old devices). Android users need a micro-USB or USB-C cable. The USB cable that came with your phone or tablet will work fine.

Connect to view photos

You use this method if the TV or monitor uses a USB input cable that displays the file from the connected storage device. First, connect the cable to the phone. Then connect the phone to the TV by plugging the other end of the standard USB cable into the TV or monitor port, changing the input on the TV to USB so you can view it.

On Android, you may need to change USB settings to **Transfer files** or **Transfer photos (PTP)** . To make changes, drag the notification from the top of the screen when connected and touch the **USB charging this device message** .

Use USB to

Charge this device

Transfer files

Transfer photos (PTP)

Use device as MIDI

CANCEL



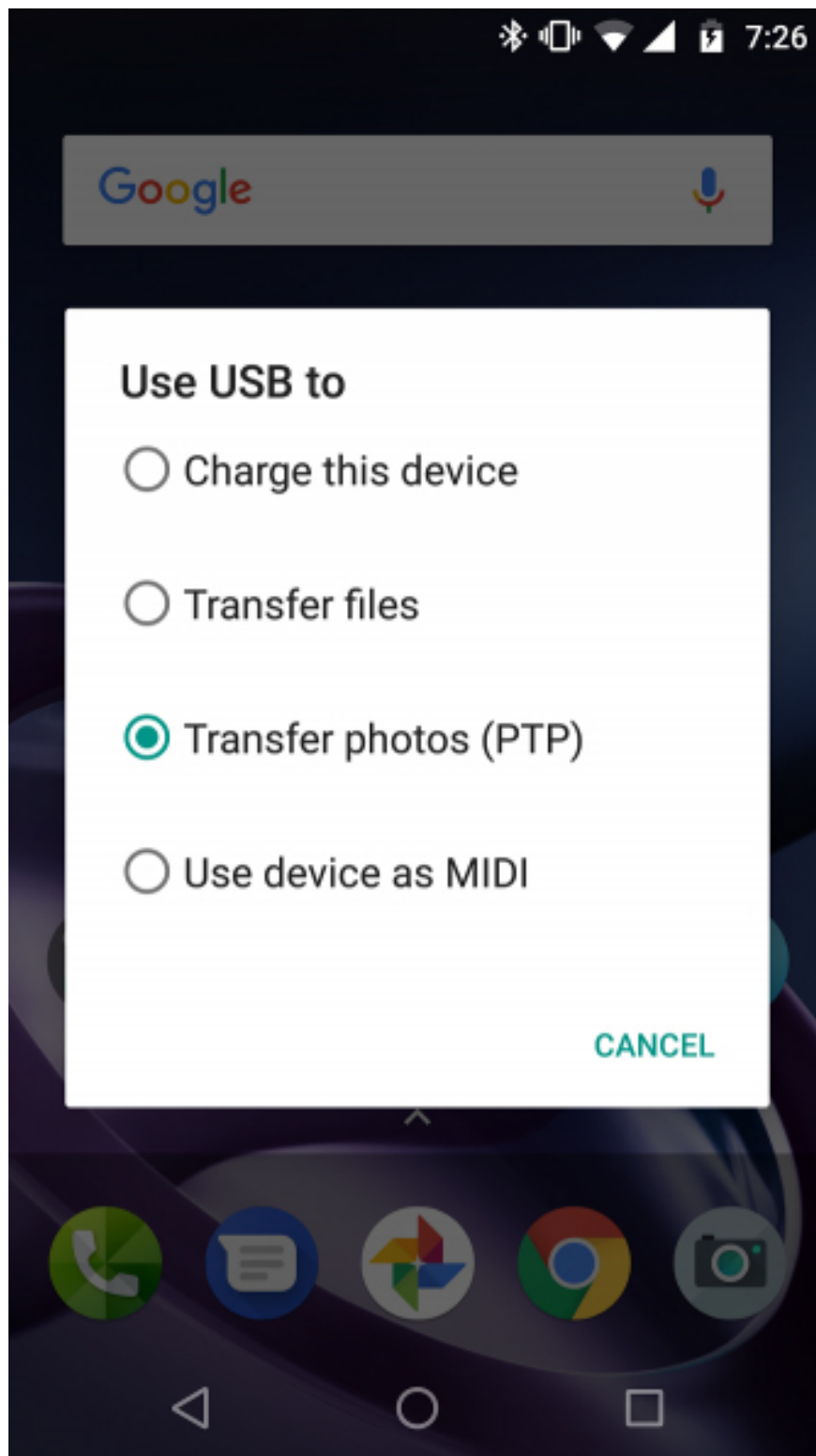

Although the USB connection to the TV varies with the device, the connection type and the display input, it is fortunate that it is not too difficult to set up and low latency.

B. Connecting the phone to the TV via the Internet



TTivi smart Sony 48 inch Full HD 48W700 with friendly internet interface

Some smart TVs have access to the Internet, offering a variety of entertainment spaces. There are three ways to connect to the Internet: using the network Hub to take advantage of the network available in the home, not using the network Hub to use the modem and network cable directly, wirelessly connecting to WiFi depending on the type of television.

C. Connect with handheld devices

1. Using NFC technology (Near-Field Communications)

NFC is a 4 cm short range wireless connection, using magnetic induction to make connections between devices when there is direct contact or close proximity. This type of connection will most likely appear in Sony's Smart TV line. They will use the One-Flick Remote Control tool to create a connection when you touch the phone near the Remote. After successful connection, Bluetooth and WiFi will assume responsibility for data transmission.

2. Screen Mirroring technology

Using this technology is quite complicated and not every TV has it. Your phone and TV must start Screen Mirroring mode, use your phone to detect TV and make connections, transfer data.

3. Swipe & Share technology

Swipe and Share is considered to be the most modern technology today, users direct devices towards the TV screen and swipe the screen in many directions. You will see the TV automatically processes and converts the content as it is on the phone. Many types of TVs also have the ability to surf the web, when the phone becomes a remote control in any position.

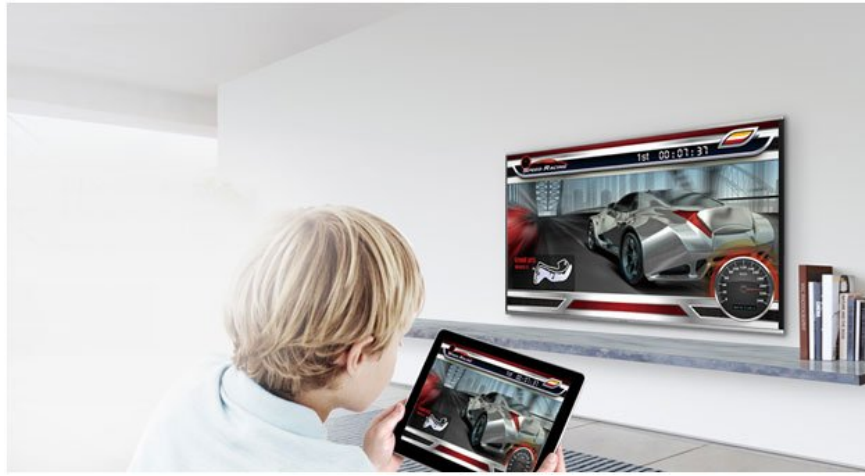

Currently, there are many types of TVs available at META.vn with different ways of connecting ports. Users can refer to the TV selection, as well as receive accurate advice to use the television properly.

Refer to the following articles:

1. Dehumidifier - an effective weapon against humid weather in Vietnam
1. Tips to distinguish real and fake Canon ink, do you know?
1. 7 note when using and storing laptops during breaks

Hope the above article is useful to you!

You finished reading the article "**Are there ways to connect your phone to a TV to watch videos?**" edited by the [TipsMake](#) team. We hope this article has provided you with many useful tech tips and tricks. You can search for similar articles on tips and guides. Thank you for reading and for following us regularly.