

Android error Wifi connection is flickering, this is how to fix the error

For smartphone users, accessing the Internet by Wi-Fi is very important. However, during Wifi connection, smartphone users often encounter some errors. Errors often encountered by users such as Wifi flickering, not catching signals, Wi-Fi connection without network access ...

For smartphone users, accessing the Internet by Wi-Fi is very important. However, during Wifi connection, smartphone users often encounter some errors. Errors often encountered by users such as Wifi flickering, not catching signals, Wi-Fi connection without network access .

In the article below, Network Administrator will guide you how to fix the Android devices with Wifi connection.

To fix the fluttering Wifi connection on Android devices, follow the steps below:

Step 1:

The first step is to open the **Settings** app on your Android device.

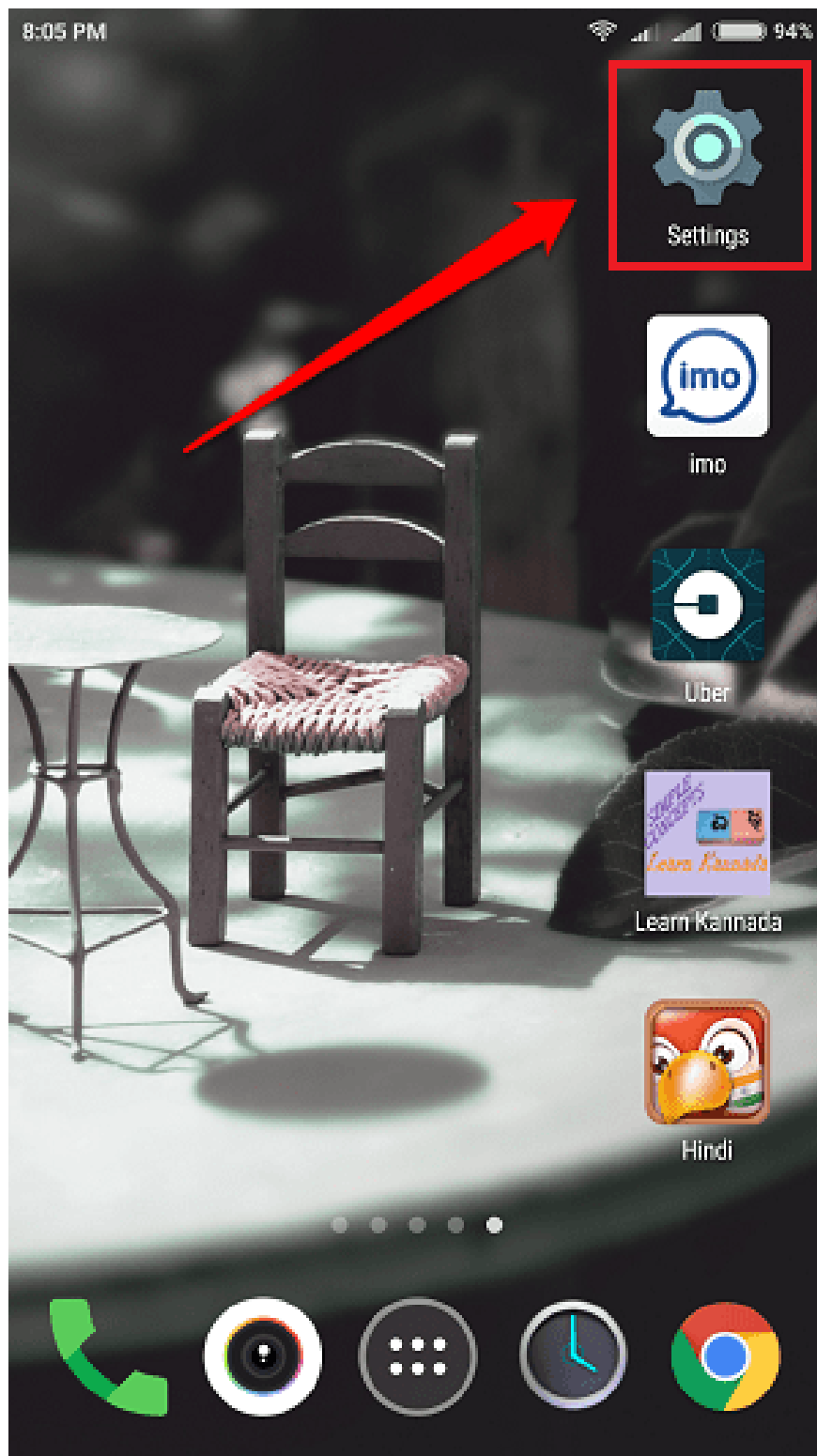

Step 2:

On the Settings application window, click **Wifi** to open the Wifi Settings window.

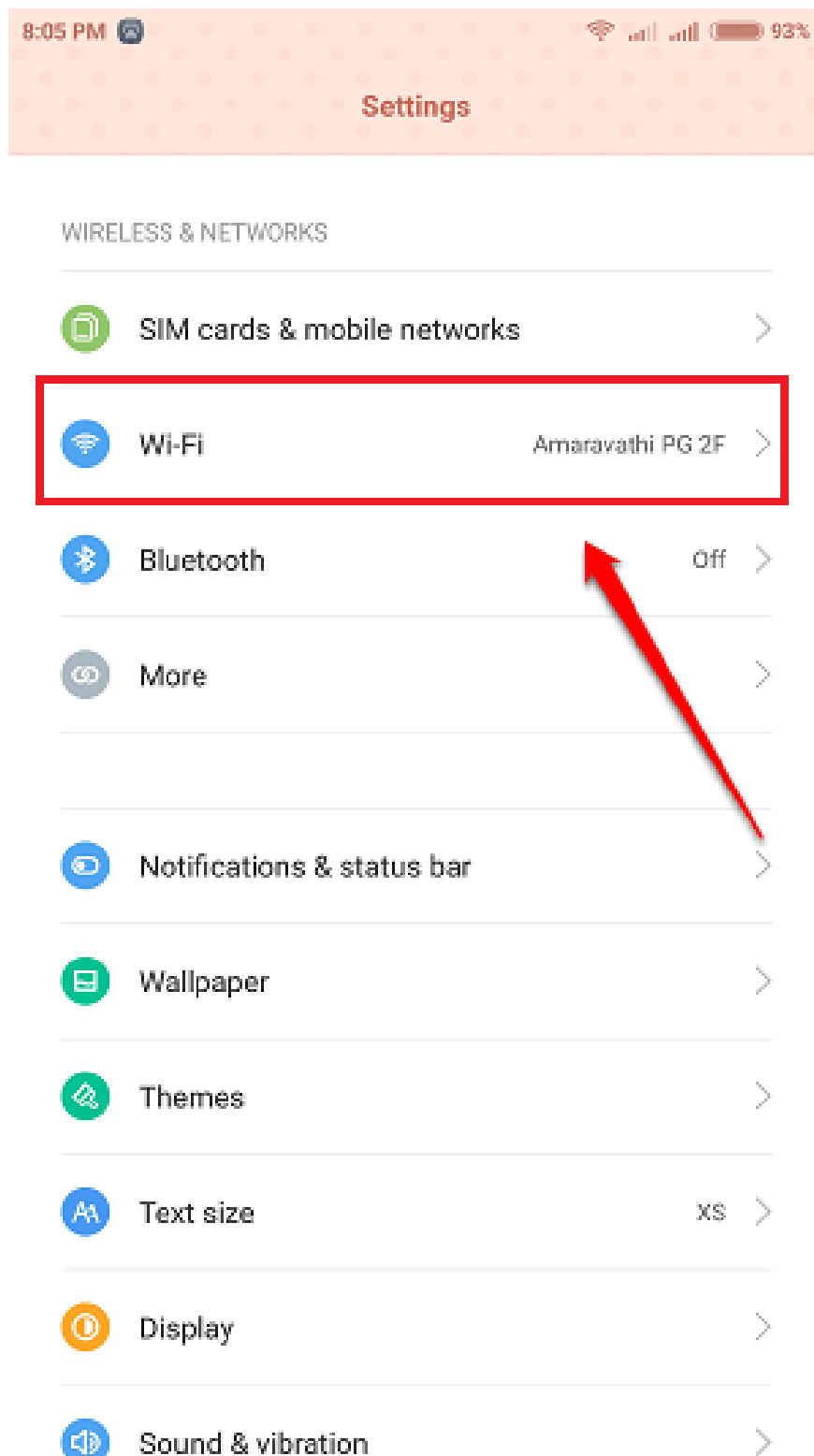

Step 3:

Scroll down to find and click the **Advanced settings** option.

On each Android line will have different interfaces. On some Android devices, you can access the Advanced Settings option by clicking the 3 dash line icon on the left side of your device screen.

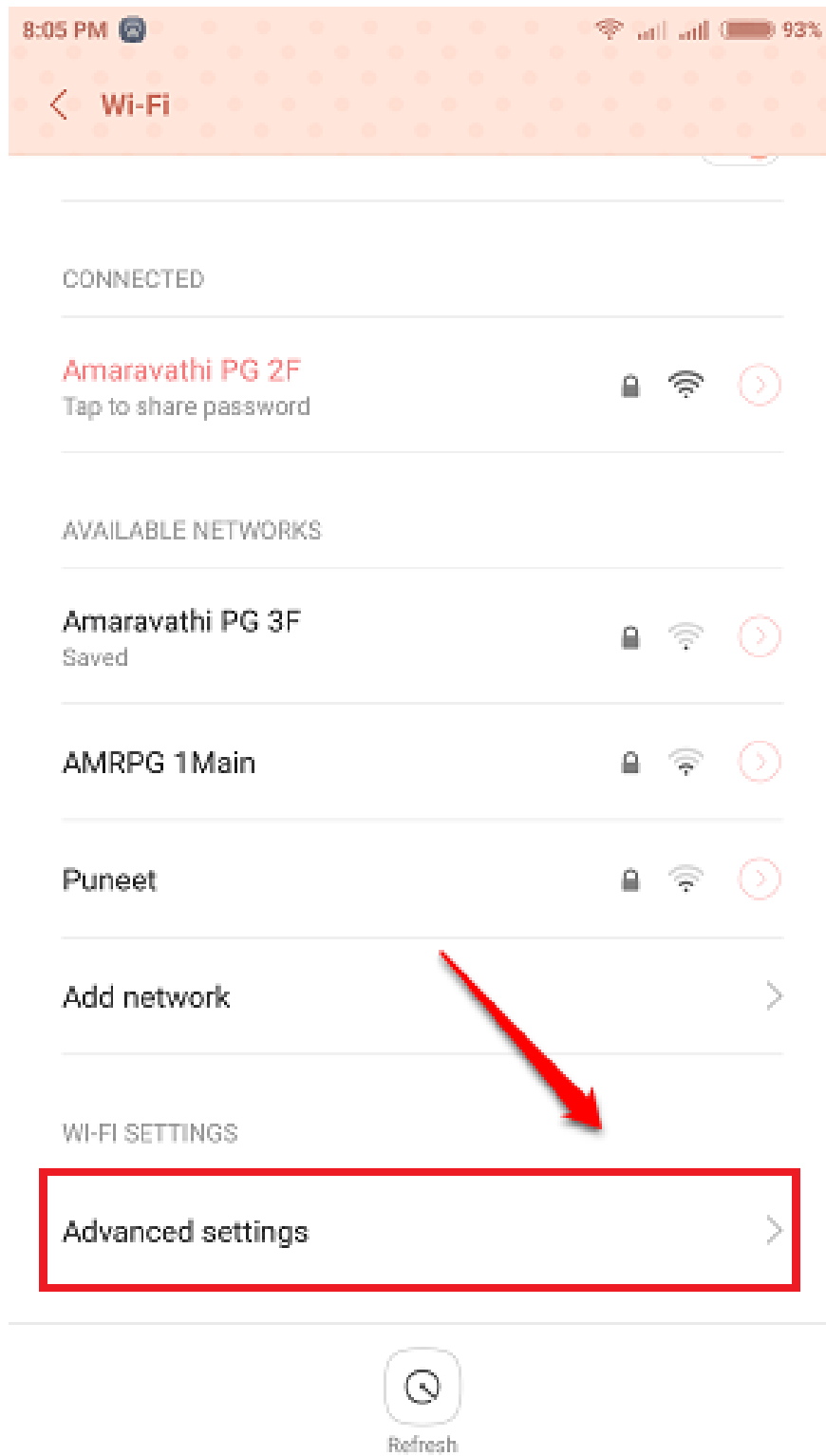

Step 4:

On the Advanced settings window, look for an option called **Keep WiFi on during sleep** and click on the option.

8:05 PM

93%

Advanced Wi-Fi

WI-FI SETTINGS

Keep Wi-Fi on during sleep

Always



Scanning always available

Let Google's location service and other apps scan for networks, even when Wi-Fi is off



Wi-Fi frequency band

Automatic



Install certificates



MAC address

74:23:44:34:39:23

IP address

fe80::7623:44ff:fe34:3923

10.0.0.8

Wi-Fi Direct



WAPI CERTIFICATES

Install WAPI certificate



Step 5:

Make sure the **Keep WiFi on during sleep option** is set to **Always** as shown below:

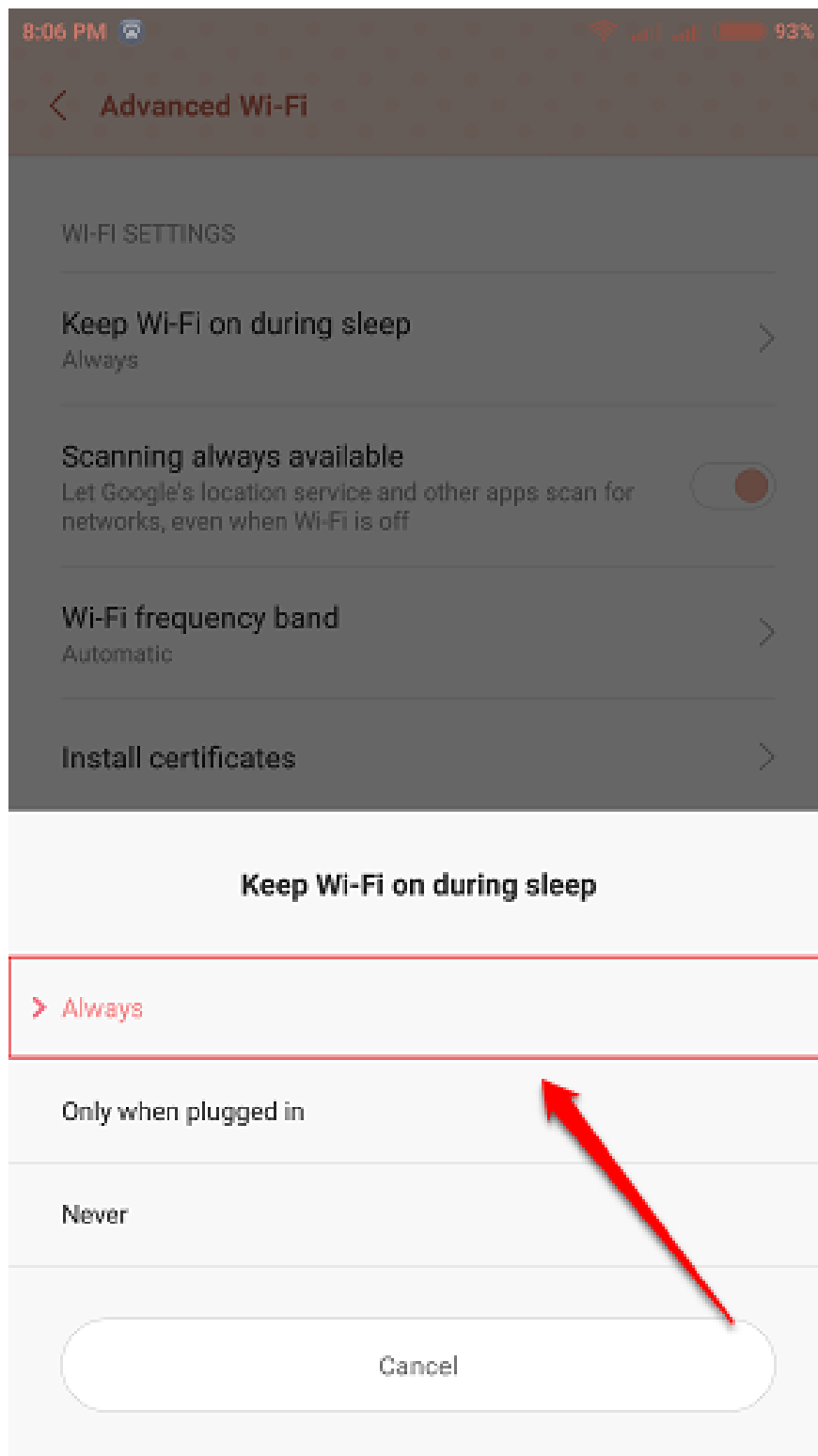

Step 6:

Also find another option called **Scanning always available** or the **Always allow scanning option** . This option checks for problems when the Wi-Fi connection is flickering.

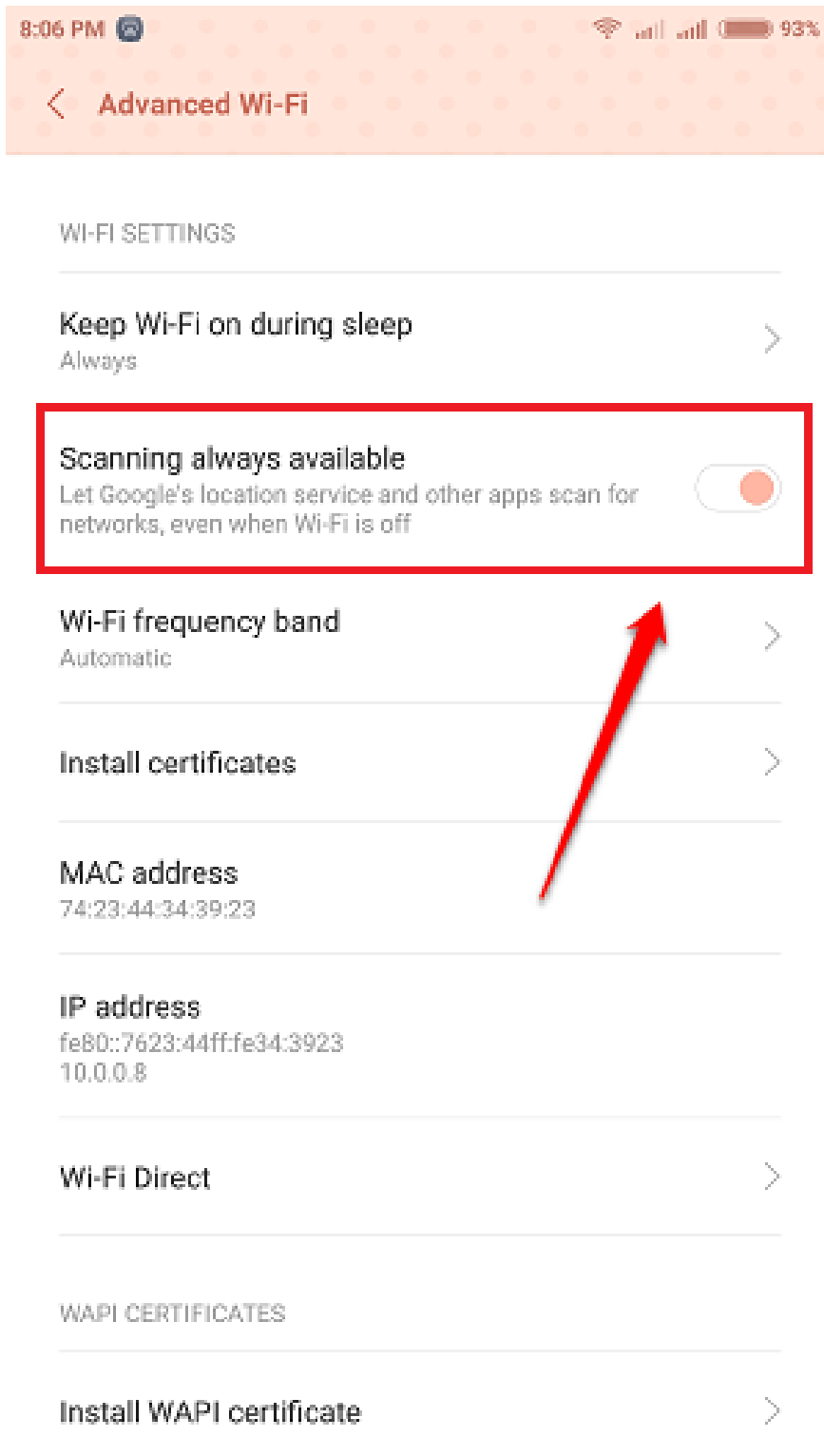

Step 7:

To fix the flickering Wifi connection, your task is to make sure that the Scanning always available option is disabled.

8:06 PM

93%

Advanced Wi-Fi

WI-FI SETTINGS

Keep Wi-Fi on during sleep

Always

Scanning always available

Let Google's location service and other apps scan for networks, even when Wi-Fi is off



Wi-Fi frequency band

Automatic

Install certificates

MAC address

74:23:44:34:39:23

IP address

fe80::7623:44ff:fe34:3923

10.0.0.8

Wi-Fi Direct

WAPI CERTIFICATES

Install WAPI certificate



Refer to some of the following articles:

1. How to transfer all data from an old Android phone to a new phone?
1. The difference between jailbreak, root and unlock

1. Add a way to hide sensitive content on Android device lock screen

Good luck!

You finished reading the article "**Android error Wifi connection is flickering, this is how to fix the error**" edited by the [TipsMake](#) team. We hope this article has provided you with many useful tech tips and tricks. You can search for similar articles on tips and guides. Thank you for reading and for following us regularly.
