

7 Ways to fix wifi connection loss on latest laptop

Wifi is unstable or disconnected, making you most uncomfortable, especially when you are working or playing games? So what is the cause of this situation? How to fix it?

While using a computer connected to the internet, if the network connection is suddenly disconnected, you can also check and fix it yourself, avoiding affecting work progress. TipsMake's article will provide you with 6 common causes and ways to fix wifi disconnection on laptops.

Reasons for wifi disconnection on laptop

To find a solution, we must first understand the cause of the Wifi Internet connection loss error. There are many causes of this error, below are some errors you need to pay attention to:



1. Laptop has not been enabled for Wifi
2. The laptop does not have a Wifi driver or the Wifi driver is old so it does not work stably.
3. Error from Router, wifi transmitter.
4. Use non-genuine IP software or VPN to change IP.
5. The laptop is infected with a virus so it cannot connect to Wifi.

How to fix lost wifi connection

Restart your computer and router.

A simple way that is often used when a laptop encounters any error is to restart the computer. Restarting the computer will help the device rest and return to a stable state, thereby overcoming the case of software conflicts

with each other.

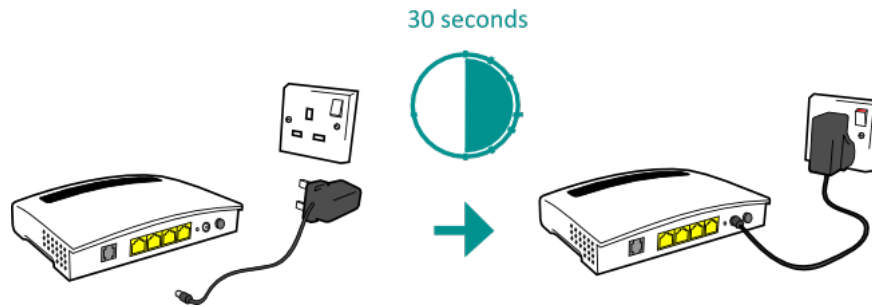

Please restart the wifi transmitter. Because this may be the reason why the laptop cannot catch wifi or it may be that the wifi has been used for a long time leading to an error, so please turn off the device for about 2-3 minutes then turn it back on to see the result.

Check network cable

Check your network cable to see if the connection is still good. For network cables, if you buy the self-crimping type or use it for a long time, the possibility of losing connection is quite high. Try turning off the device, removing the cable from the router and turning it back on, after about ten seconds for the device to boot up, reinstall the cable. If the signal light corresponding to the cable port starts flashing continuously, your network cable is still working well. If not, you may have to crimp the cable again.

Check connection in Control Panel

Step 1: Access Control Panel by searching for the application on the Taskbar. With Control Panel you can check deep inside the network card.

Step 2: Then, go to Change Adapter Setting inside Network and Sharing Center.

Step 3: Finally if the network card is disabled (it is grayed out), right click and select Enable.

With this method, you can fix the Wifi error or lost connection in Win 10 and Win 11.

Delete WiFi connection

It is possible that the Wifi has lost its internet connection due to the processing of the WiFi password. Try opening the WiFi connection section and right-clicking on the connected WiFi. Then, select Forget and reconnect to the WiFi from the beginning.

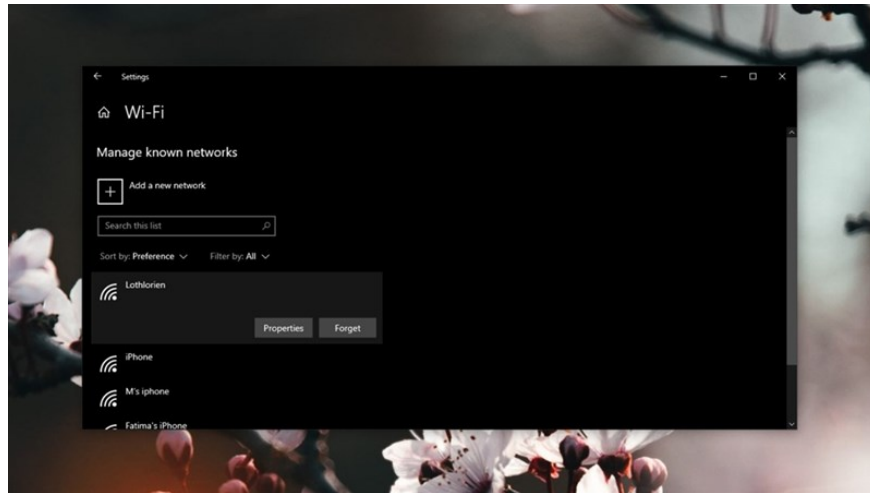

Check Wifi Driver

Your laptop's wifi is lost, most likely because you haven't installed the wifi driver for your computer or the computer driver is old. After checking if your computer has installed the wifi driver, follow these steps:

Step 1: Click on My Computer >> Select Manage.

Step 2: When the Manage window appears, then click on Device manager and check in the Network adapter column to see if the wifi driver is displayed (the wifi driver will usually have the words Wireless Network)

Step 3: If you have not installed the Wifi driver, you must use another device to download the driver, then copy it to USB and reinstall it. If you cannot download the wifi driver or cannot find the driver, you can use All in one driver automatic installation software such as Driver Booter or Wandrive to automatically reinstall it.

Refresh IP address

Step 1: Click the Windows icon on the keyboard and type Command Prompt. Then press Enter.

Step 2: The cmd window appears, you use the command `ipconfig /release`. Next, press Enter to execute: This command helps you delete the old IP that is causing the error.

Step 3: Finally, type the command `ipconfig /renew` to refresh the computer's IP address.

Do not turn on battery saving mode on laptop

You should not turn on battery saving mode on your computer. In this mode, your devices will have to reduce brightness, performance and computer connections. Open the battery section on your laptop and drag the adjustment bar to the middle to turn off this mode!



Conclude:

Above is a summary of the causes and solutions to the wifi connection loss errors on laptops that we often encounter. Wish you to successfully fix the problem after reading this article!

You finished reading the article "**7 Ways to fix wifi connection loss on latest laptop**" edited by the [TipsMake](#) team. We hope this article has provided you with many useful tech tips and tricks. You can search for similar articles on tips and guides. Thank you for reading and for following us regularly.