

7 tips for typing 'shorthand' on Windows Phone

The following simple tips will help you improve your typing skills on Windows Phone phones.

The following simple tips will help you improve your typing skills on Windows Phone phones.

1. Press the way button twice to type the dot

This is probably the simplest tip and you probably already know. Just press *the button twice* and you can finish the sentence quickly.

2. Enter the number or symbol quickly

Want to quickly type a number or symbol? One way you should try is to press and hold the **& 123** key and drag to the number you want to enter. But if you want to enter a sequence of numbers, then perhaps pressing **& 123** and entering numbers in the normal way will be faster.

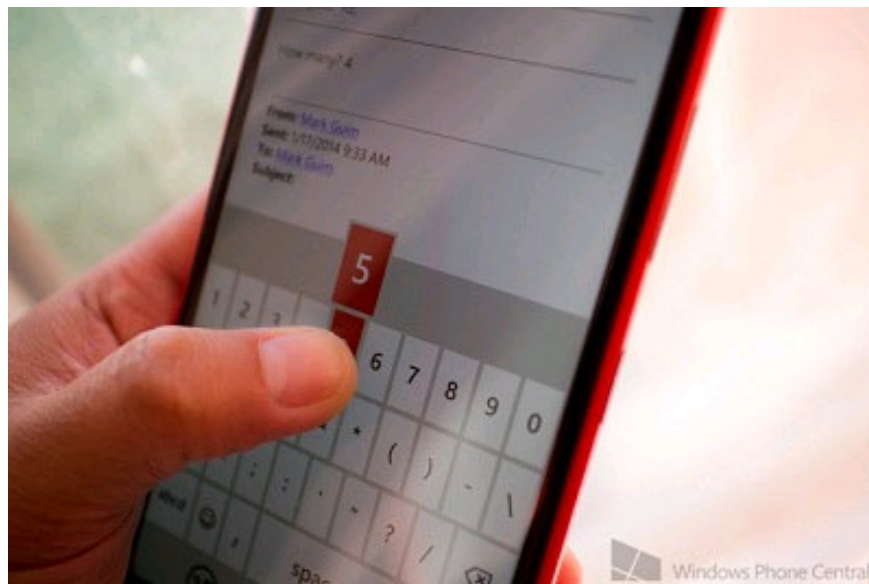

3. Enter punctuation marks quickly

You need to know how to quickly terminate a sentence with an exclamation point or question mark? Hold the dot button (.) And drag to the punctuation button you need. Very simple!

4. Quickly enter the .org, .edu or .net extensions

When you type a web address, a default .com key will appear on the keyboard. But what if you want to type *.org*, *.edu* or *.net* ? Just press and hold the *.com* key and slide to the tail you want.



5. Press and hold to type uppercase letters

You probably already know that you need to press the **Shift** key (up *arrow*) before typing a capital letter. If you want to type all the characters in uppercase, there are two options for you: press *anyone to Shift* , or press and hold it.

6. Quickly enter emoticons

Do you use emoticon keys to add smileys and hundreds of other emoticons? There is an installation that you should know to type faster: go to **settings** -> **keyboard** -> **advanced** and click on the label " *switch back to letters after I type an emoticon* ". Removing this item will help you enter many consecutive symbols during the editing process.



7. Add words to the list of suggestions (Word Flow)

One of the features of the Windows Phone keyboard is the *Word Flow* feature, which means the device will give you a hint when you're typing. Sometimes it even corrects spelling mistakes for you. If there is a word that you use often that the phone is unknown, it will automatically remember. You can also manually enter new words manually by typing first, then press the word to select it. Press the plus key to add the word and the list of suggestions.

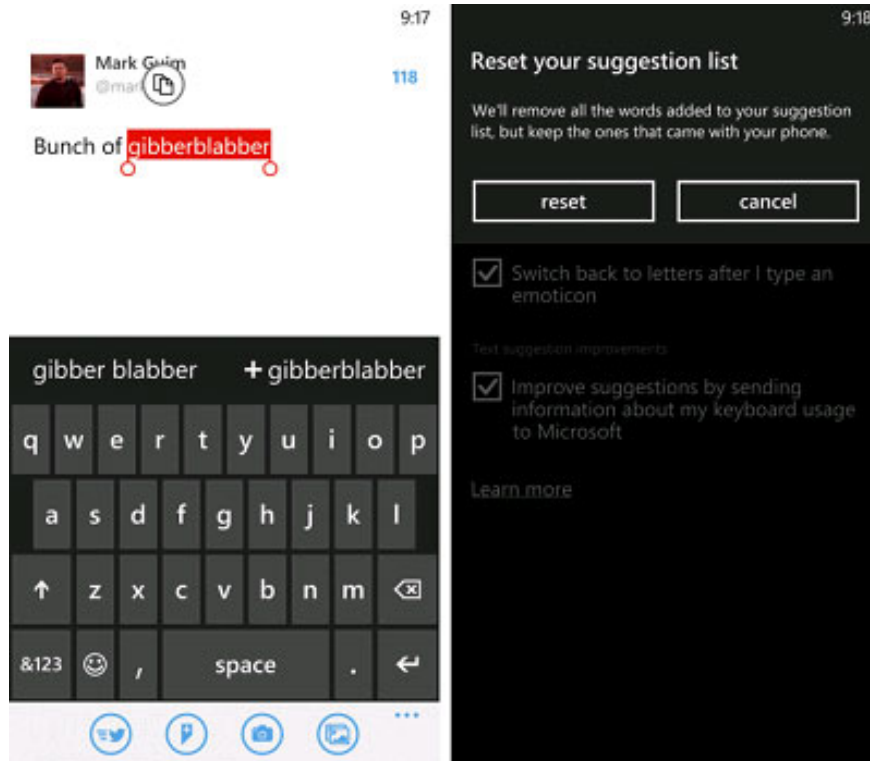

You can reset the suggestion list by going to **settings** -> **keyboard** -> **advanced** and clicking the "*reset suggestions*" button.

You finished reading the article "**7 tips for typing 'shorthand' on Windows Phone**" edited by the [TipsMake](#) team. We hope this article has provided you with many useful tech tips and tricks. You can search for similar articles on tips and guides. Thank you for reading and for following us regularly.
