

Step 3:

After inserting the check mark into the PowerPoint slide, you can change the color and size to your liking.

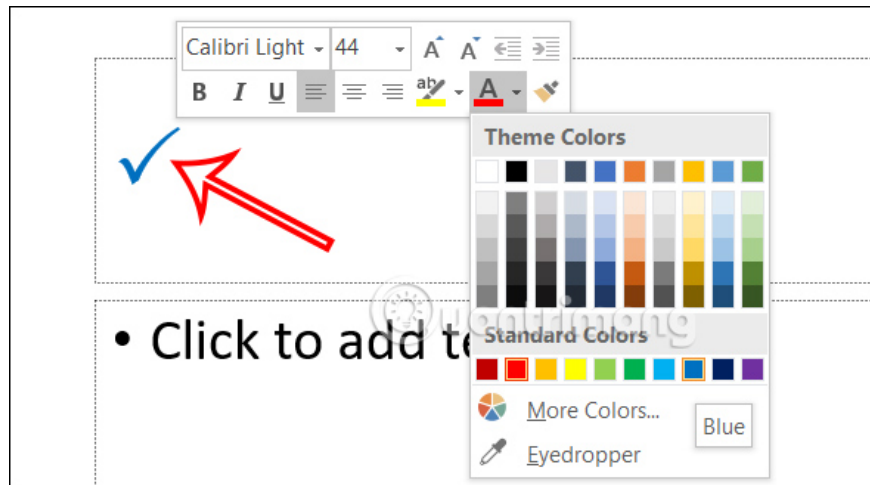

How to add ticks in Powerpoint using Icons

In the Icons section, there will be a check mark option for you to insert into the content in the PowerPoint slide.

Step 1:

You also click on Insert then click on **Icons** below to open the icon in the slide.

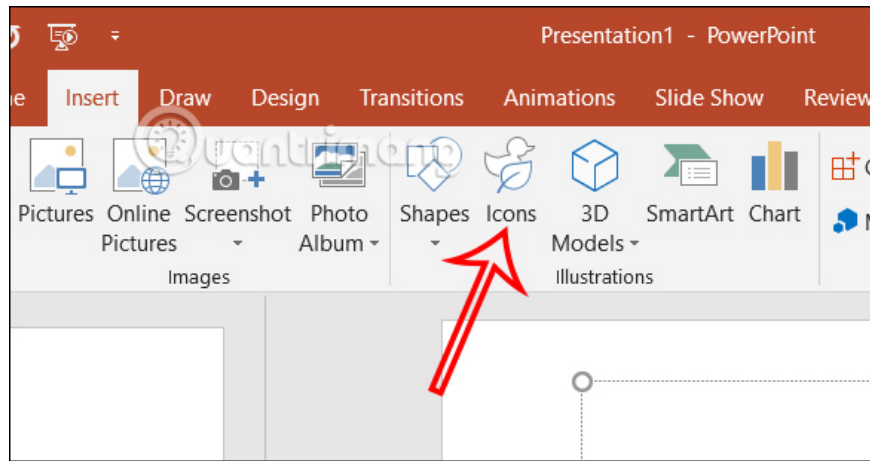

Step 2:

To display the interface of icon groups in PowerPoint, **enter the tick keyword** and then display the tick icon in the slide. Click on the check mark and **select Insert** to insert into the Powerpoint slide.

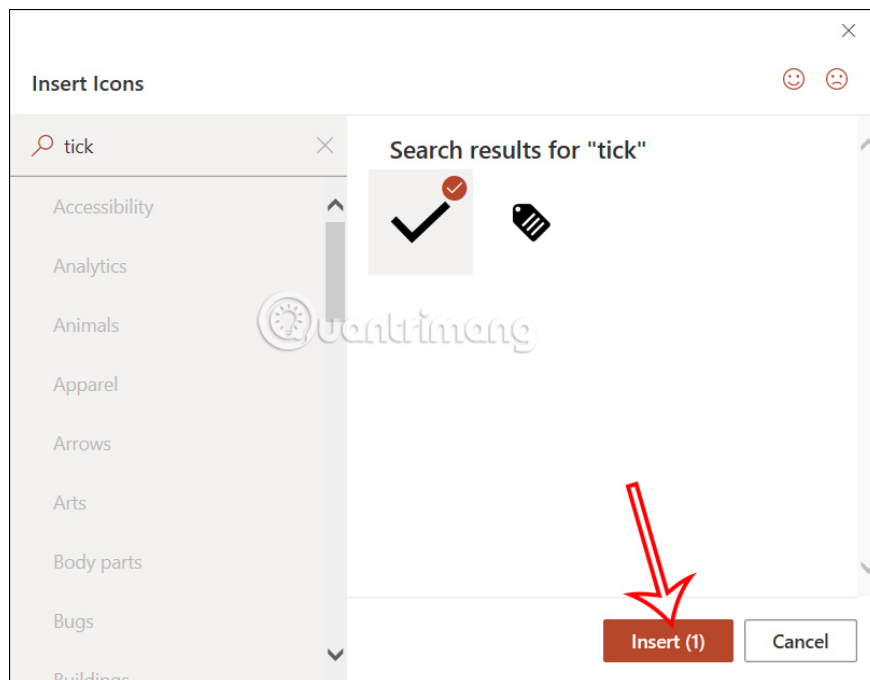

Instructions for inserting checkmarks into PowerPoint using AutoCorrect

Step 1:

In the PowerPoint interface, click **File** and then select **Options** .

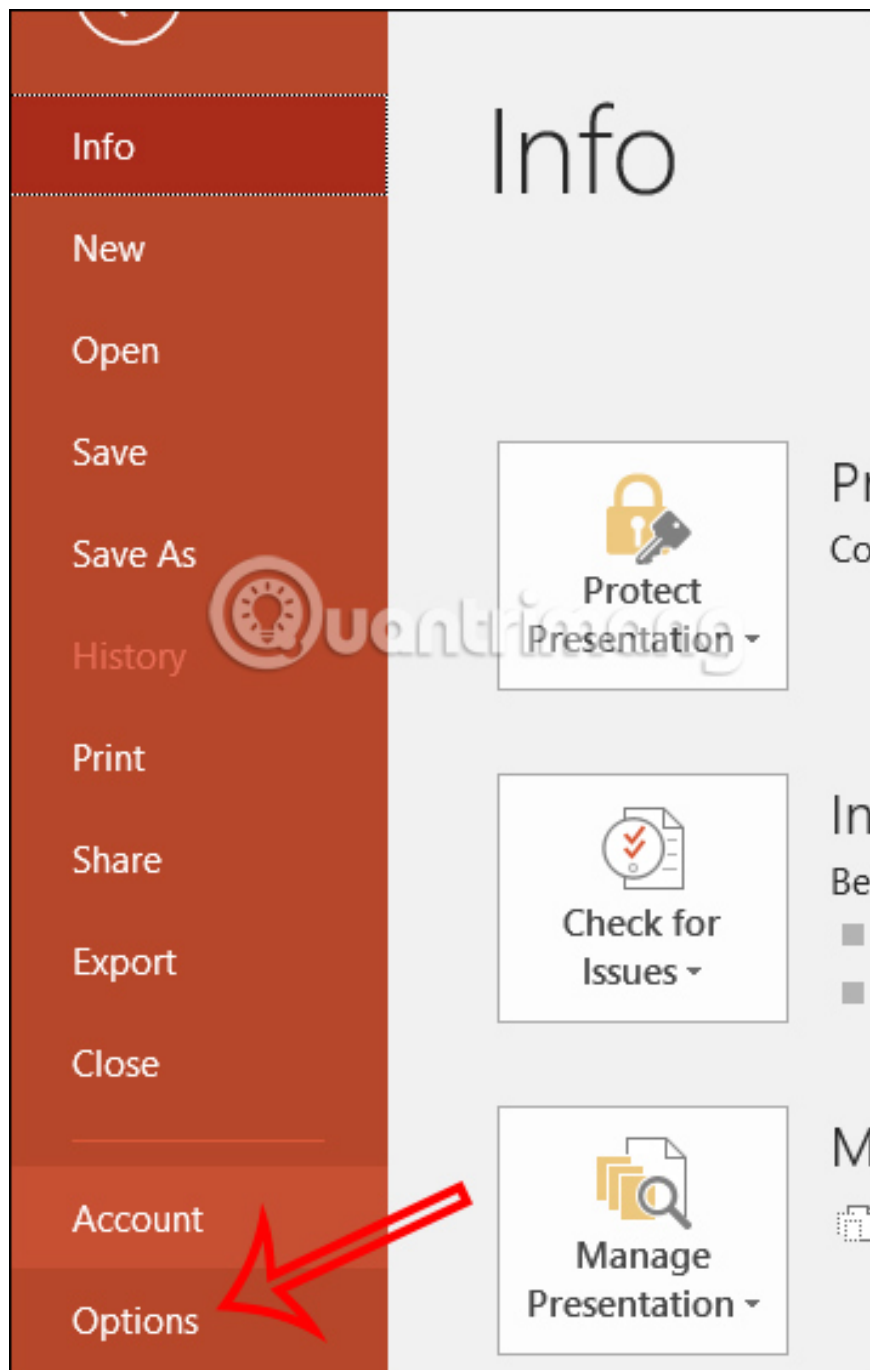

Step 2:

Switching to the PowerPoint slide settings interface, users click on **Proofing** and then click on **the AutoCorrect Options button** .

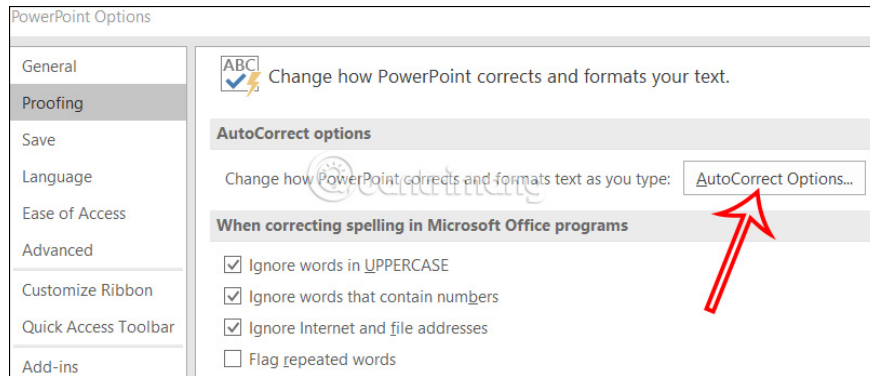

Step 3:

Displays the shortcut setting interface. In the **AutoCorrect** section , enter the '~' character in the **Replace** box to enter a check mark. Next, in the **With** box, enter the character ?? and press the **Add** button to add . Click next to complete.

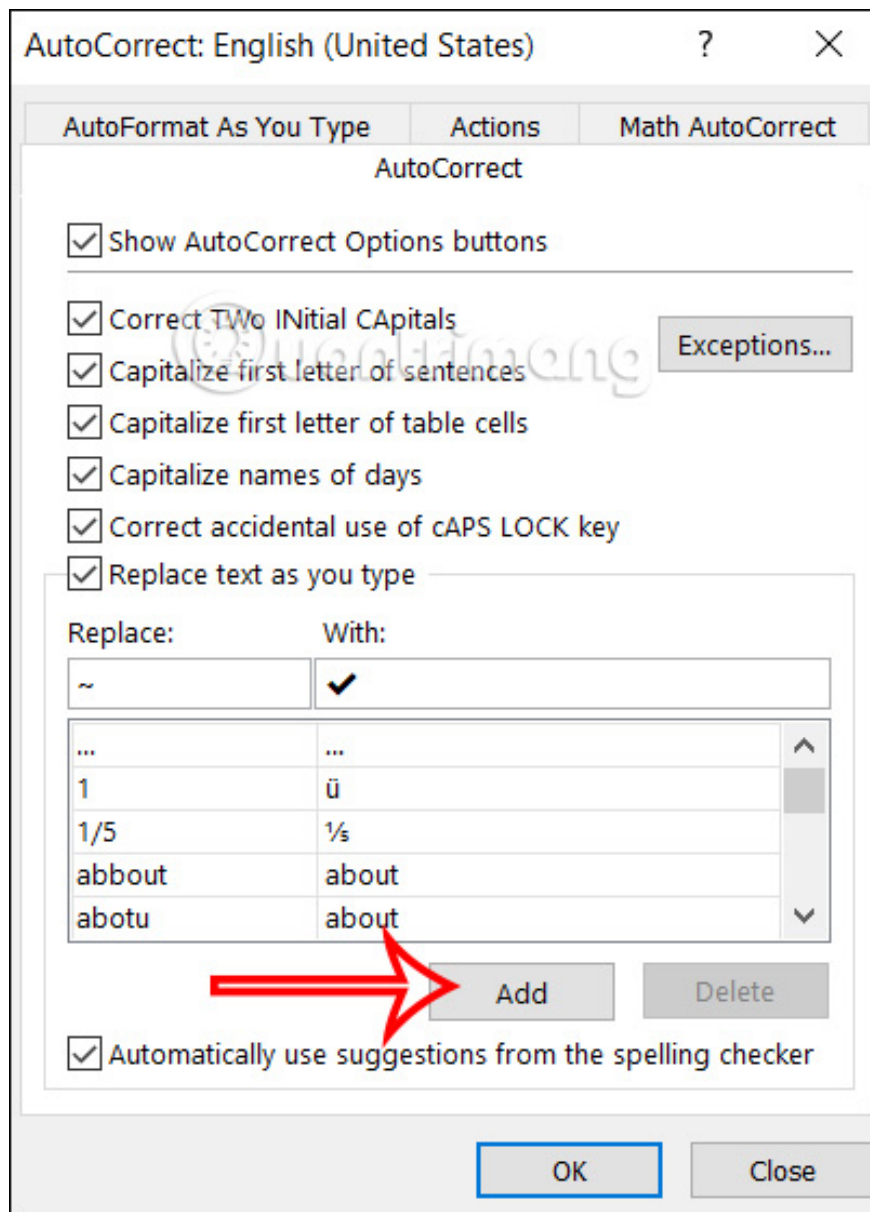

Step 4:

Return to the PowerPoint slide, **press Shift + ~** to display the check mark in PowerPoint.

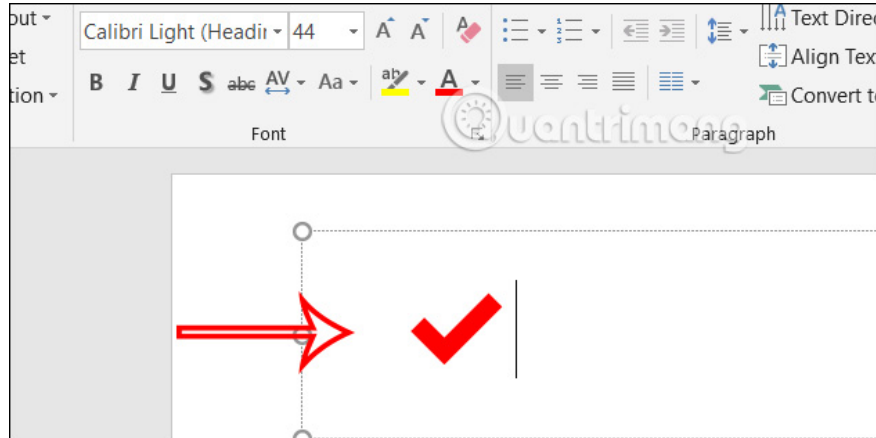

Insert traces in PowerPoint via Character Map

Character Map in Windows contains special characters for you to insert into slides, including check marks.

Step 1:

In the search bar on your computer, **enter the keyword Character Map** and then click on the search result.

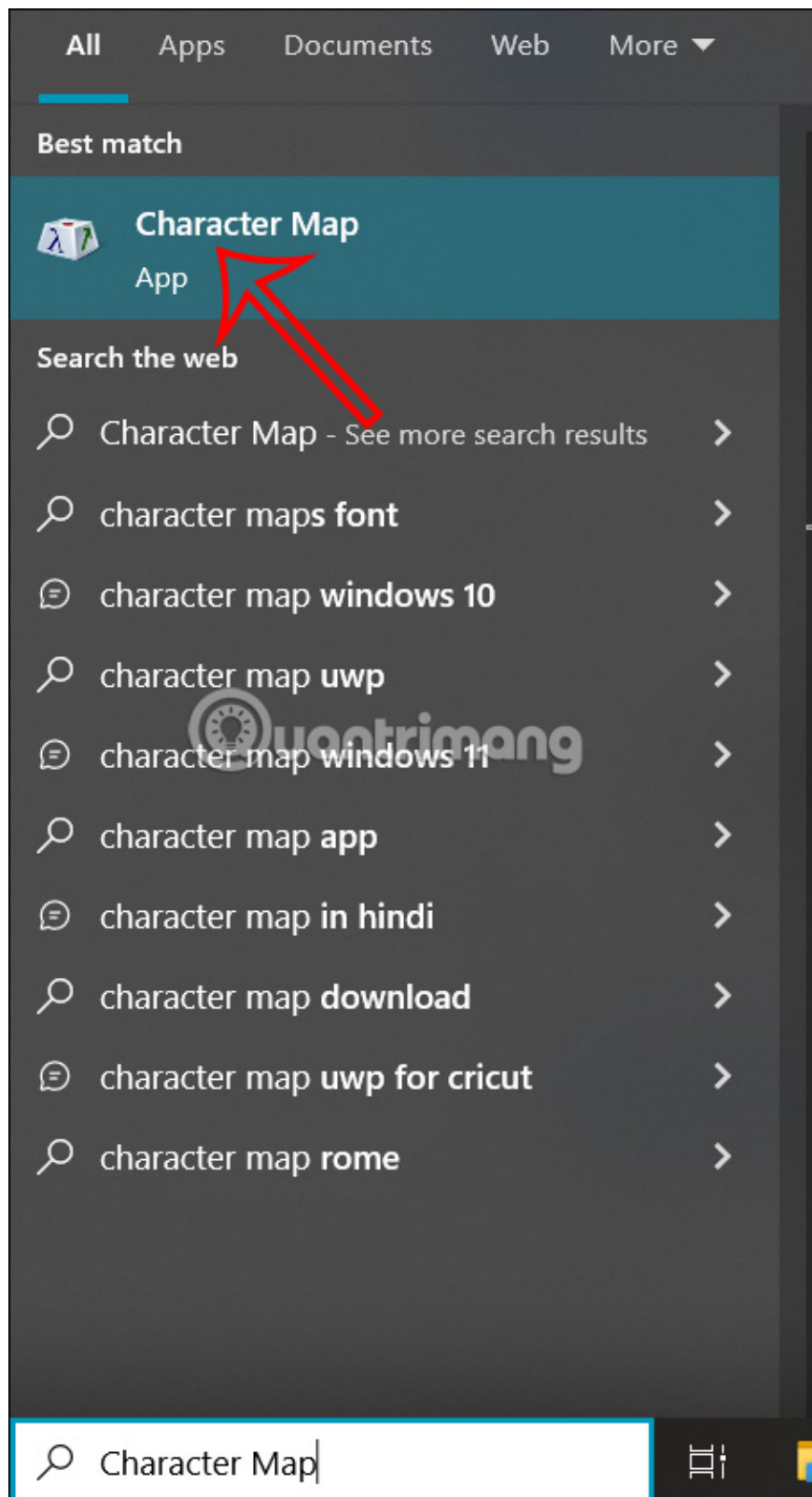

Step 2:

We find the **Wingdings font** , then below you find and **select the check mark icon** , click on **Select** to display it in the Characters to copy frame. Now you just need to **click Copy** to paste into PowerPoint.

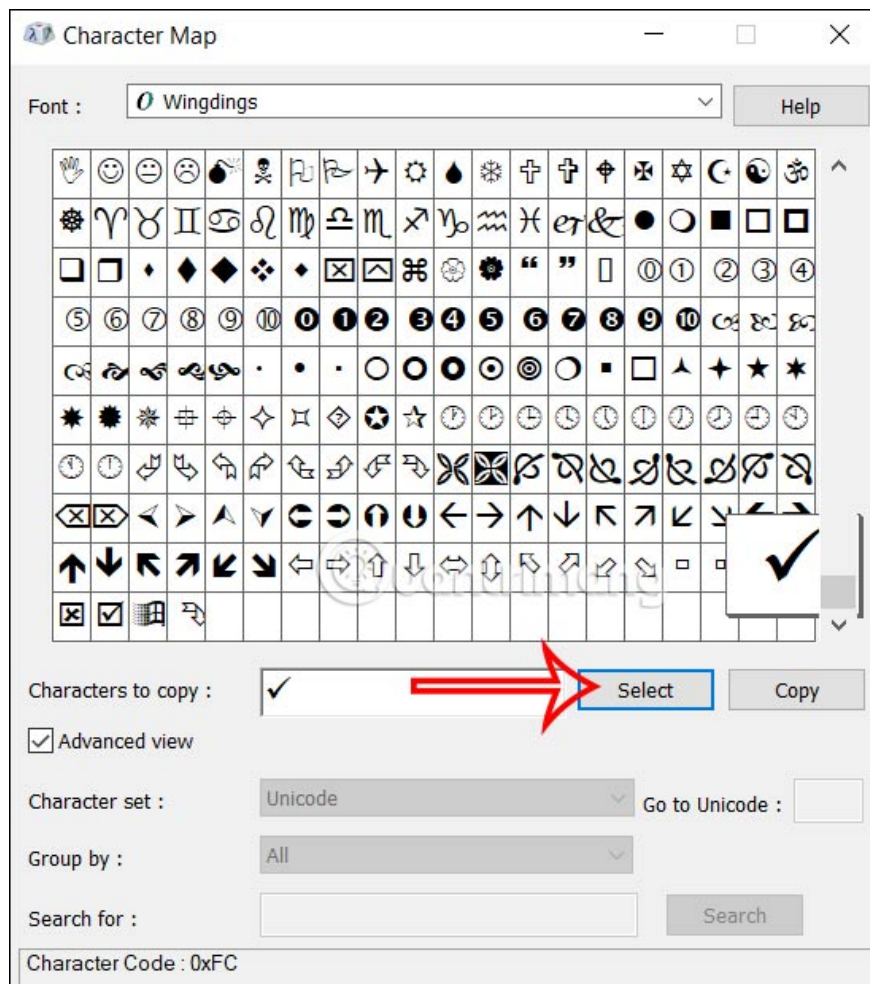

How to insert check marks into PowerPoint using Alt Codes

Step 1:

In the PowerPoint interface, **press the key combination Alt + 0220** to display characters as shown below to display lowercase characters.

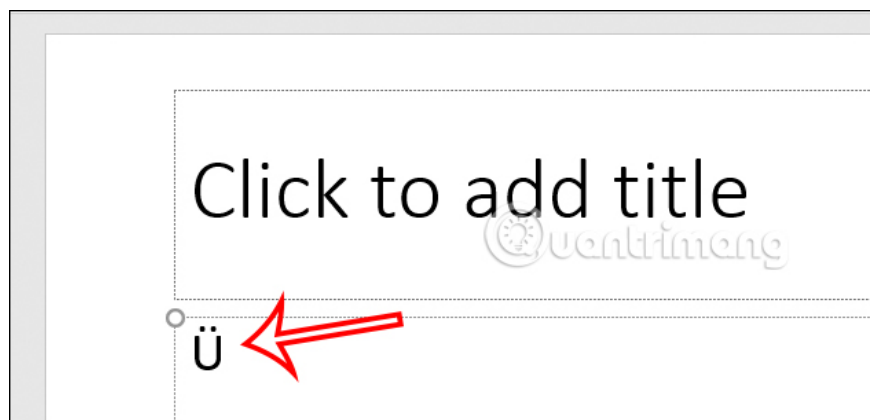

Step 2:

Next, we highlight the character and then switch to the Wingdings font as shown below. The check mark will immediately appear in PowerPoint.

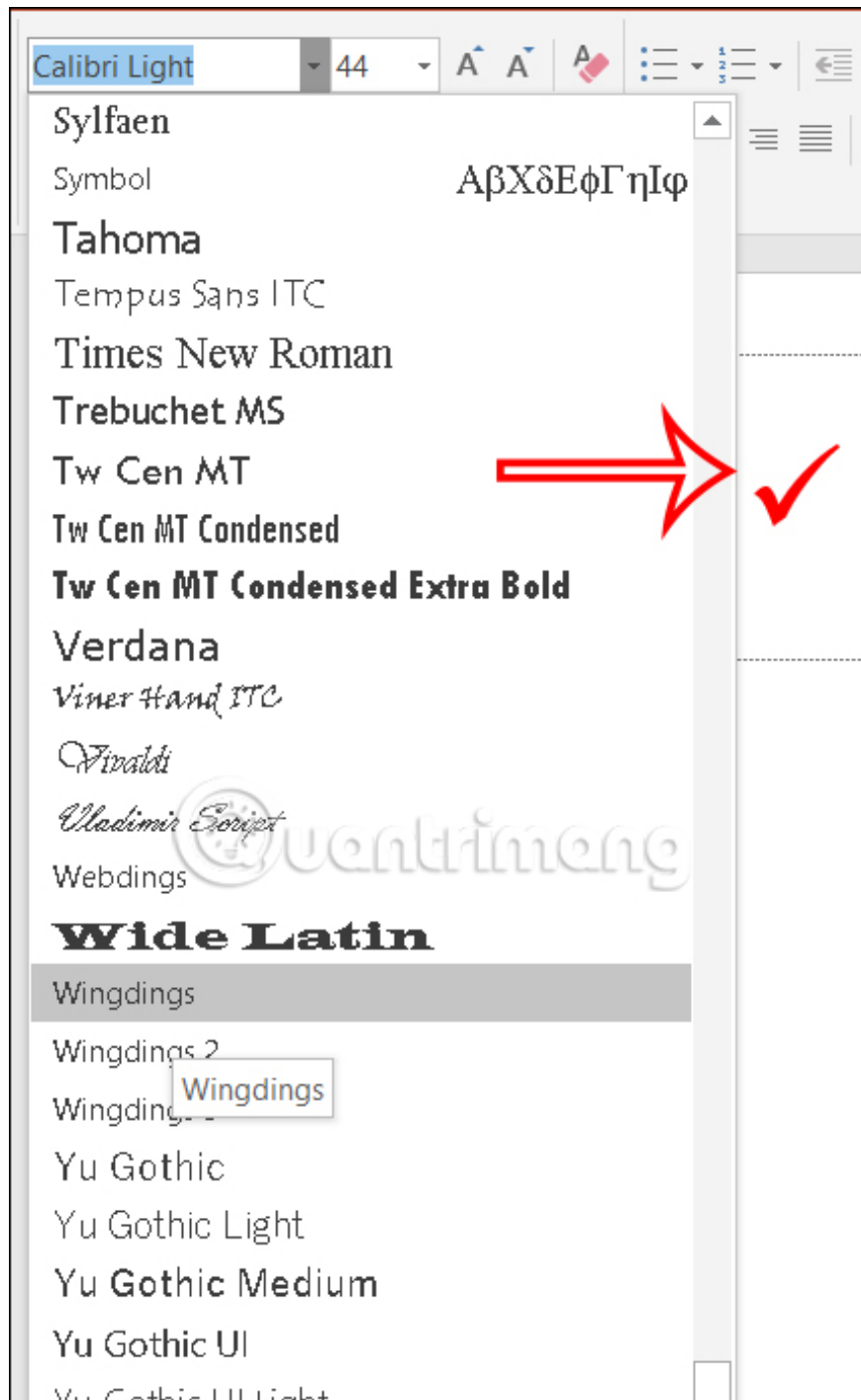

You finished reading the article "**5 very simple ways to insert check marks in PowerPoint**" edited by the [TipsMake](#) team. We hope this article has provided you with many useful tech tips and tricks. You can search for similar articles on tips and guides. Thank you for reading and for following us regularly.