

4 Reasons You Should Stop Personalizing AI Chatbots

After trying this feature out for a while, here are 4 reasons why you should stop personalizing your chatbot.

AI chatbot personalization is the latest trend, as ChatGPT , Gemini , Copilot , and other chatbots now offer personalization features. Sharing your preferences may seem helpful, but it can backfire and create unwanted responses. After trying this feature for a while, here are 4 reasons why you should stop personalizing your chatbot.

Note : The author's experience comes mainly from ChatGPT and Google Gemini personalization. There may be chatbots that handle personalization better, but these issues exist in both chatbots, with ChatGPT being slightly better.

They may give biased answers.

Honestly, this is the expected result. After all, chatbots are known to agree with users. When you tell AI what you like and don't like, they try not to give you direct answers that contradict you. This means you'll often get answers that take your preferences into account.

For example, the author asked Gemini to "rank the best Linux distributions for gaming" and it ranked Pop!_OS first because it knew the author had used this distribution.

Top Linux Distros for Gaming

1. Pop!_OS (Where you are now!)

- **Why it's great for you:** You're already on it! Pop!_OS is highly regarded for gaming due to its excellent hardware support, including out-of-the-box support for NVIDIA and AMD drivers. It also has a "Gaming Mode" and System76's CPU scheduler designed to improve performance. It's user-friendly and based on Ubuntu, meaning there's a lot of online support. It's often cited as performing as well as, or even better than, Windows for gaming in some cases. [🔗](#) [🔗](#) [🔗](#)
- **Good for:** New users, users with NVIDIA or AMD GPUs, those who want a stable yet performance-oriented system. [🔗](#)

2. Nobara Linux

- **Why it's great:** Created by GloriousEggroll (the person behind Proton-GE), Nobara is a modified version of Fedora specifically designed for gaming and streaming. It includes many gaming-related tools and tweaks pre-installed, along with necessary proprietary packages and codecs that Fedora might not include by default. It aims to be very "point-

However, when running the same search (copy/paste) without personalization, Nobara Project ranked first on the list, Pop!_OS ranked 5th. Such bias can be really bad for your experience because it can prevent you from finding new things and make you confident that whatever you're doing is right, even if it's not optimal.

Top Linux Distros for Gaming

1. Nobara Project

- **Why it's #1:** Nobara is specifically designed for gaming, streaming, and content creation. It's a modified Fedora build by GloriousEggroll (creator of Proton-GE), meaning it includes a lot of gaming-focused tweaks, drivers (like NVIDIA), and necessary dependencies (like Wine and codecs) right out of the box. This significantly reduces the need for manual configuration, making it incredibly user-friendly for gamers. It aims for a "point and click" experience. [🔗](#)
[🔗](#)
- **Pros:** Excellent out-of-the-box gaming experience, pre-installed drivers, gaming-specific optimizations, and a focus on user-friendliness.
- **Cons:** Not an official Fedora "Spin," so support might be more community-driven. [🔗](#)

2. Bazzite

- **Why it's #2:** Bazzite is a strong contender, often called a "SteamOS clone" for PCs. It's built on Fedora and aims to provide a Steam Deck-like experience with out-of-the-box support for Steam games, HDR, and VRR. It also includes System76's CPU scheduler for improved gameplay and various community-developed tools. [🔗](#) [🔗](#)

Increased likelihood of AI hallucinations

AI illusion is a common problem, and hackers have even used it to carry out hijacking attacks. AI chatbots create illusionary information and present it as fact, often in a way that makes it difficult to refute their claims. Personalization further exacerbates the problem of AI illusion because it often focuses on queries with your personal information at the forefront.

Even if you ask a question about something completely different, it will try to connect the dots to turn the question into your personal information. This often results in the AI forcibly connecting the information to your personal information and lying.

For example, the author asked Gemini about using RCS in Google Messages when setting up dual SIM. Knowing that the author was using Linux, it somehow connected the Android query to Linux. It confidently gave instructions for Android apps on Linux. It even called Google Messages the default messaging app on Pop!_OS.

How to check and manage RCS for your numbers in Google Messages:

1. **Open Google Messages:** Launch the Google Messages app on your Pop OS machine (it's the default messaging app).
2. **Access Settings:**
 - Tap your **profile picture** (usually in the top right corner).
 - Select **Messages settings**.
3. **Go to RCS Chats:**
 - Tap on **RCS chats**.
4. **Manage SIMs:** In this section, you should see options related to your SIM cards. If dual SIM RCS is supported and active, you'll likely see a status for each of your numbers (e.g., "Connected," "Setting up," or "Disconnected"), and you might have toggles to enable or disable RCS for each specific SIM.

Forced to clarify what not to do

Typically, if you ask a question without providing any context, AI chatbots will make a best guess and are usually right. This means you can start most conversations without going into detail about exactly what you're talking about, saving time. With personalization enabled, it will try to connect the query to your personal information if it's even partially relevant. This can lead to incorrect information being provided or the AI asking additional questions for clarification.

For example, the author asked ChatGPT a simple query about encountering a BSoD after updating a driver. The Blue Screen of Death (BSoD) is a Windows-only error, so it would normally guess that you are experiencing a Windows issue. However, instead, it started asking for more details because it knew the author was using Linux, forcing the author to clarify that he was using Windows.

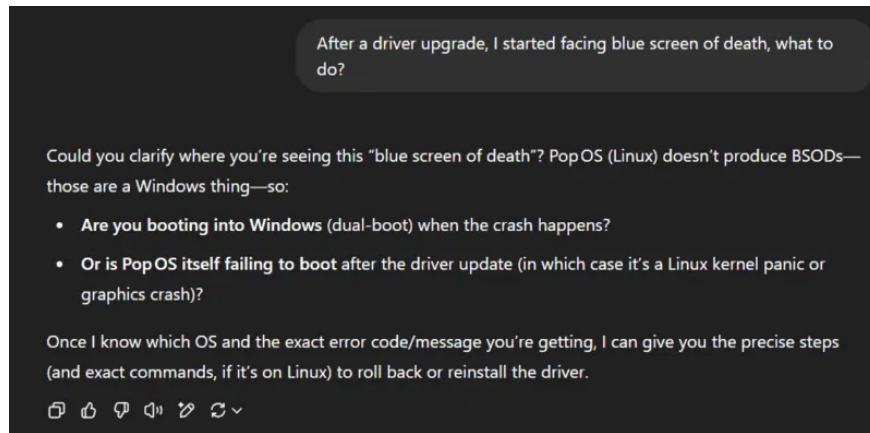

AI wastes response and token space by adding extra information

AI chatbots process information using a token system. Since AI responses are so resource intensive, this token system allows the chatbot to manage the length of its responses based on the user's question and package, just like the free or paid version. Therefore, all information in the response is limited by this token system; any additional information that you don't need will still cost you tokens.

With personalization, any question you ask that is even partially related to personal information, the AI ??will waste some tokens to provide more information.

For example, the author spoke to Gemini about Windows Defender and how it works with third-party antivirus programs. There was no mention of Linux, but decided to dedicate a section to Linux to repeat the same example given about Windows. This space could be used to provide more information about Windows.

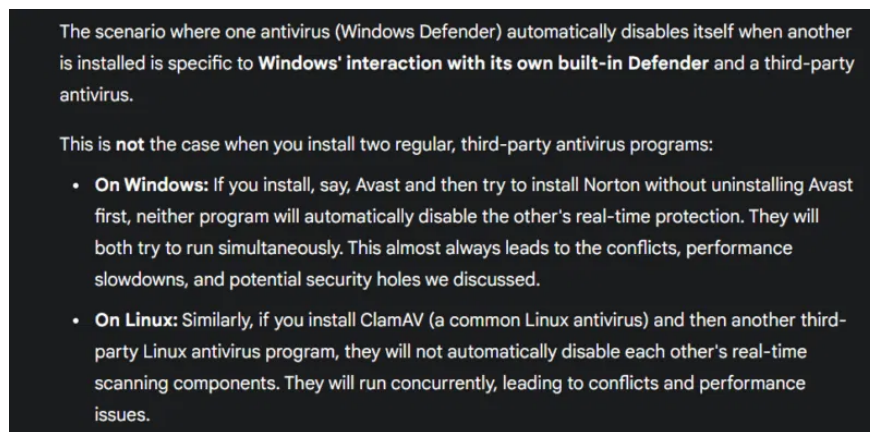

Personalization can make information more relevant, but it can also lead to inaccurate and biased responses, making it difficult to trust the answers. Turn off personalization on any AI chatbots you use! Instead, try to craft your prompts in a way that helps you get the exact answer you need.

You finished reading the article "**4 Reasons You Should Stop Personalizing AI Chatbots**" edited by the [TipsMake](#) team. We hope this article has provided you with many useful tech tips and tricks. You can search for similar articles on tips and guides. Thank you for reading and for following us regularly.

